

Montageanleitung V096.3

Eckeinstieg

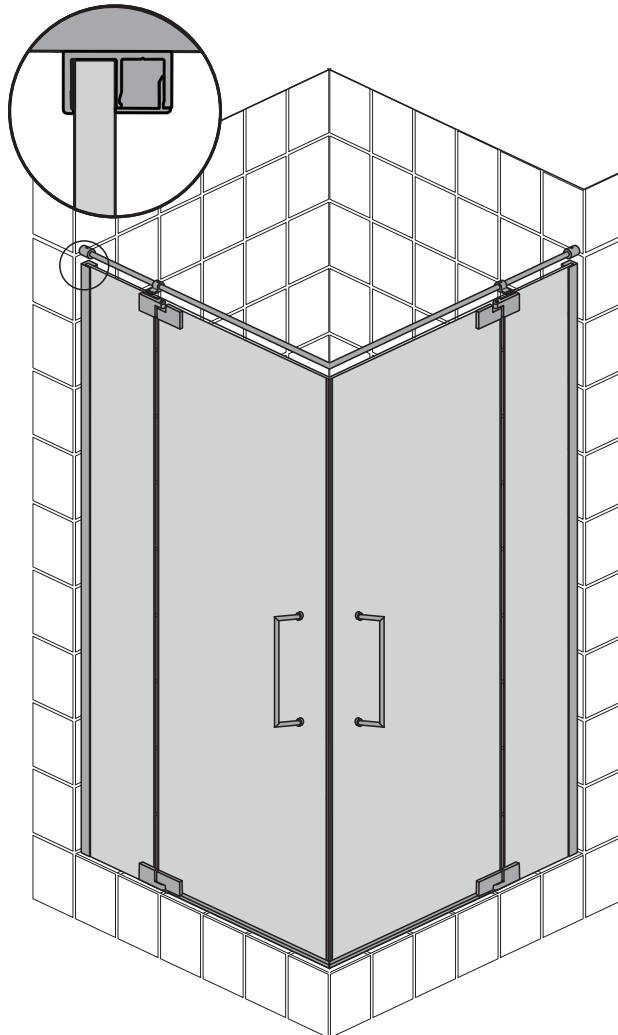

Keine scheuernden Putzmittel verwenden !
Do not use scouring powder !

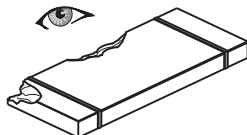

Die Kabine vor Montage auf Transportschäden überprüfen.
Für bereits montierte Objekte kann kein Schadenersatz geleistet werden.

Check the product for transport damage prior to mounting.
Products that have already been mounted will not be replaced.

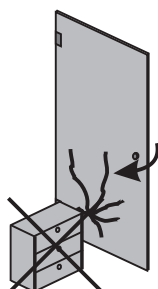

Es ist sicherzustellen, daß die Türflügel beim Öffnen auf keine harten Flächen oder Kanten anschlagen können.
BRUCHGEFAHR !

Make sure the wall does not bump against hard surfaces or edges when opened.
RISK OF BREAKAGE !

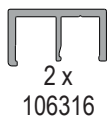

2 x
106316



8 x $\varnothing 6$
106537



8 x $\varnothing 4,2 \times 45$
106538



8 x M4
101385



6 x
104354



6 x
106318
+ 106319

1



Montage Eckhlfte rechts spiegelbildlich !

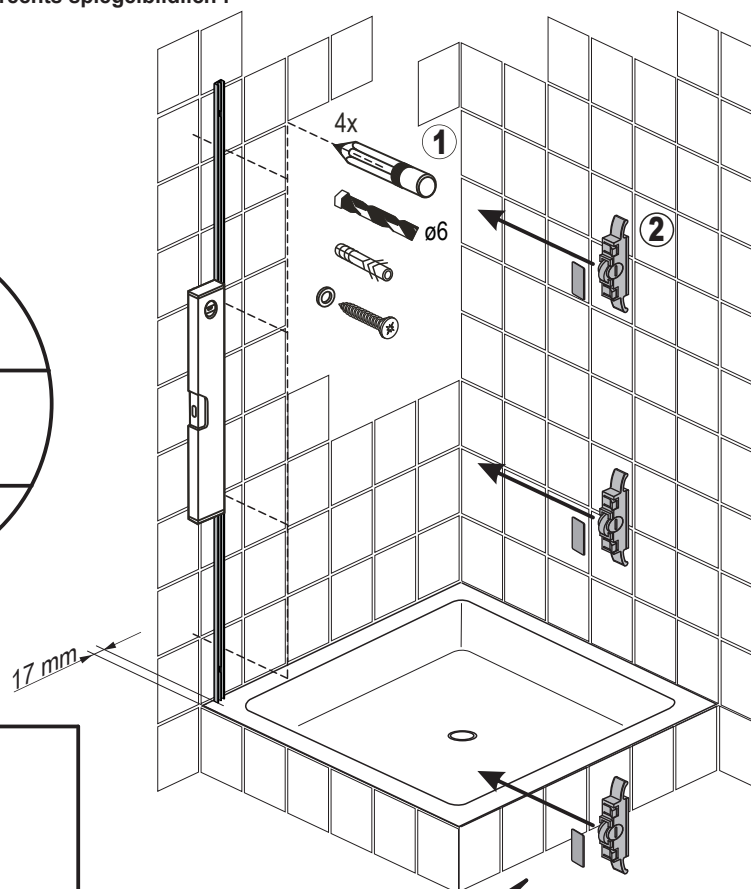
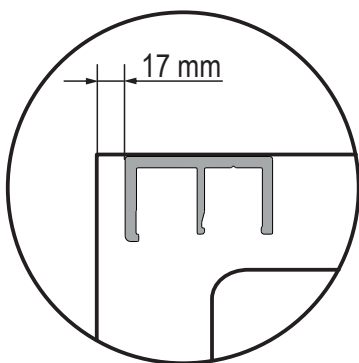

A

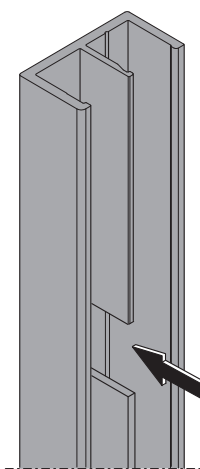

3x

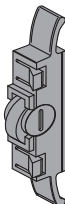

B

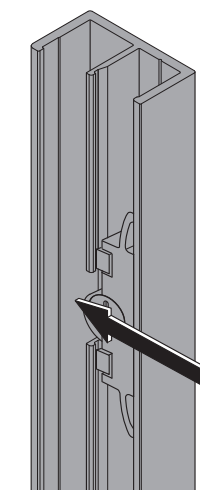

3x

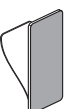

2 x 106647 /
106648

2 x 106317



Für den entsprechenden Untergrund geeignetes Silikon verwenden.
Oberfläche vor dem Silikonieren gründlich reinigen (fettfrei).
Use suitable Silicone for the respective base material.
Thoroughly clean the surface prior to the silicone on

2



Montage Eckhälfte rechts spiegelbildlich !

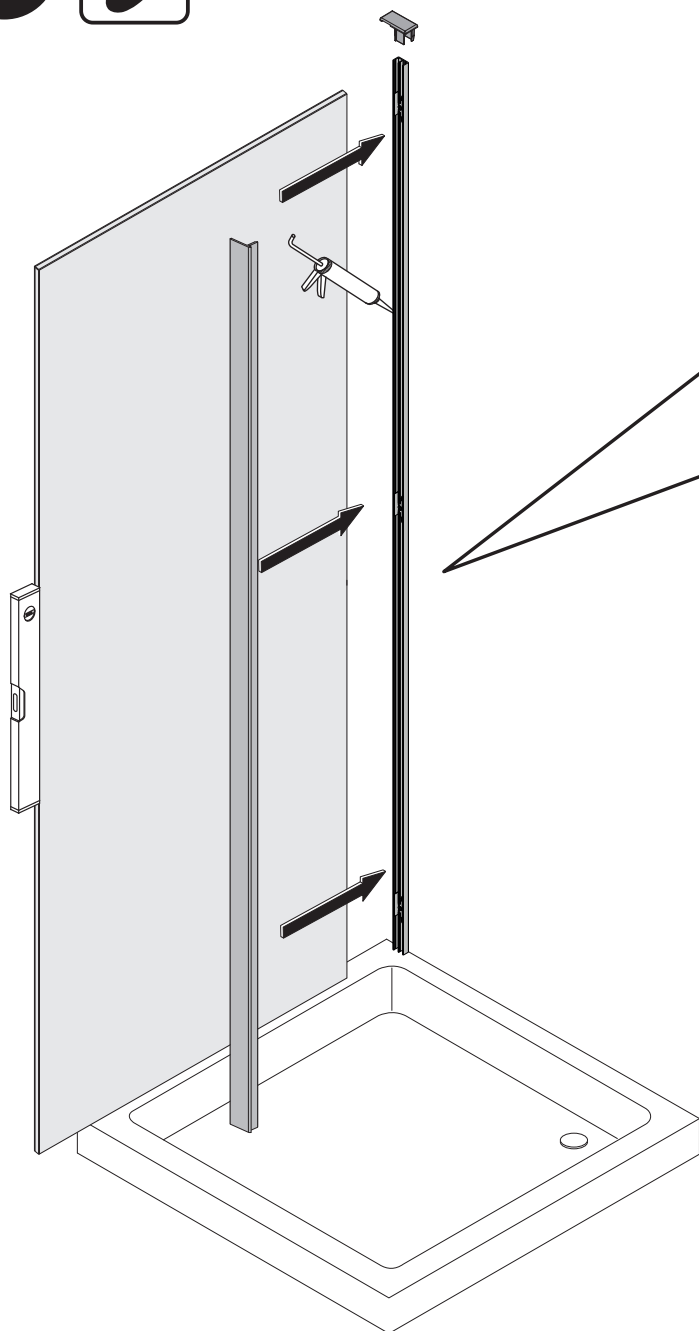

A

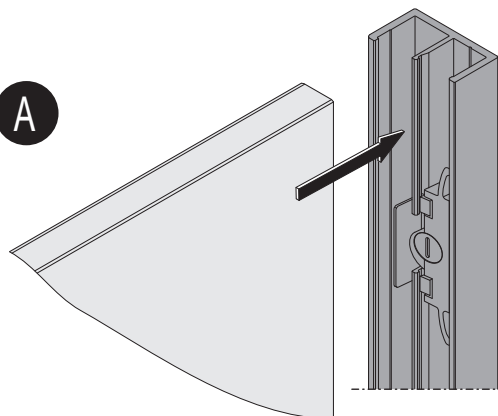

B

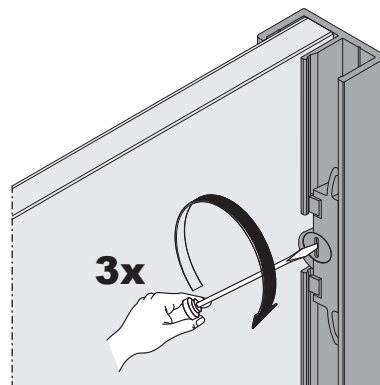



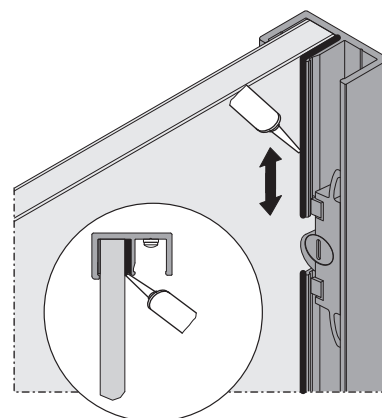



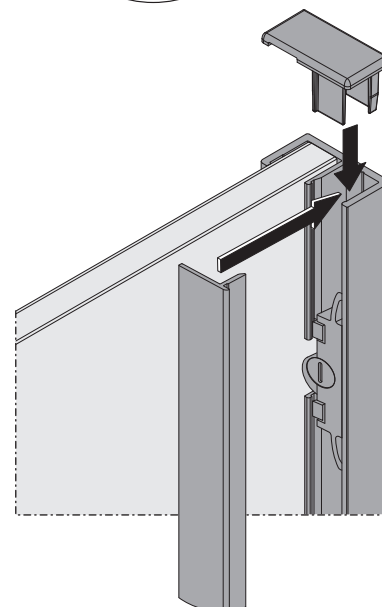







C



D



														
1 x	1 x	1 x	1 x	1 x	1 x	2 x	2 x	2 x	2 x	2 x	1 x	1 x	1 x	2 x
104858	105888	104837	104808 (104809)	104806 (104807)	104793	103970	104789	101174	102095	104895	104819	103637		

3



Montage Eckhlfte rechts spiegelbildlich !

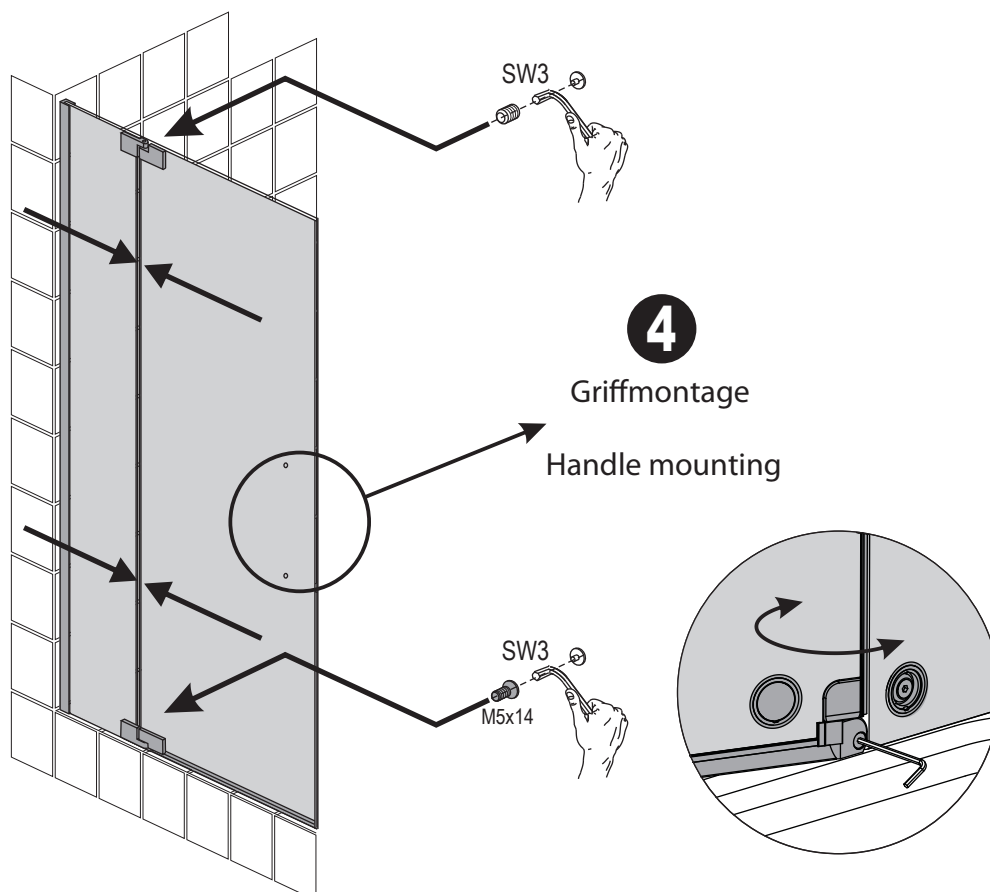
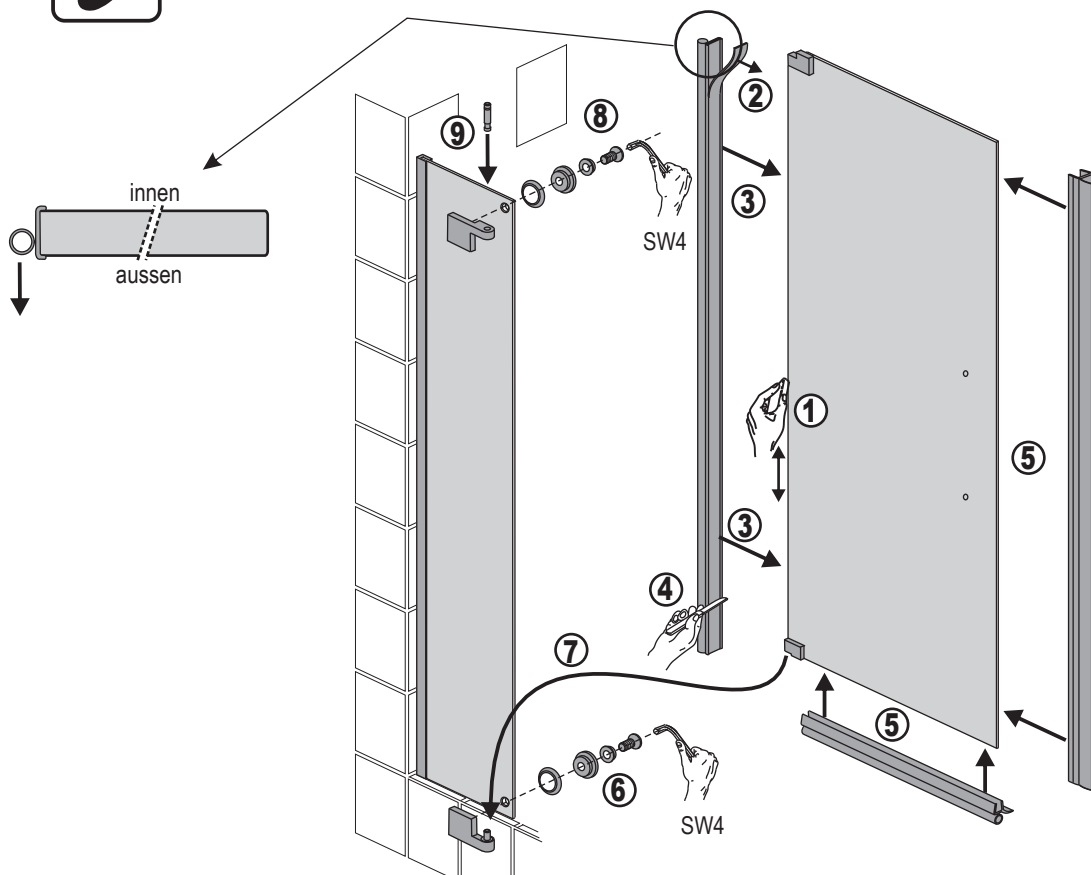

4

Griffmontage

Handle mounting

2 x
104776

4 x M4x12
101909

4xM6x5
101006

2 x ø4,2x45
100887

2x
103805

2xø6
100956

6

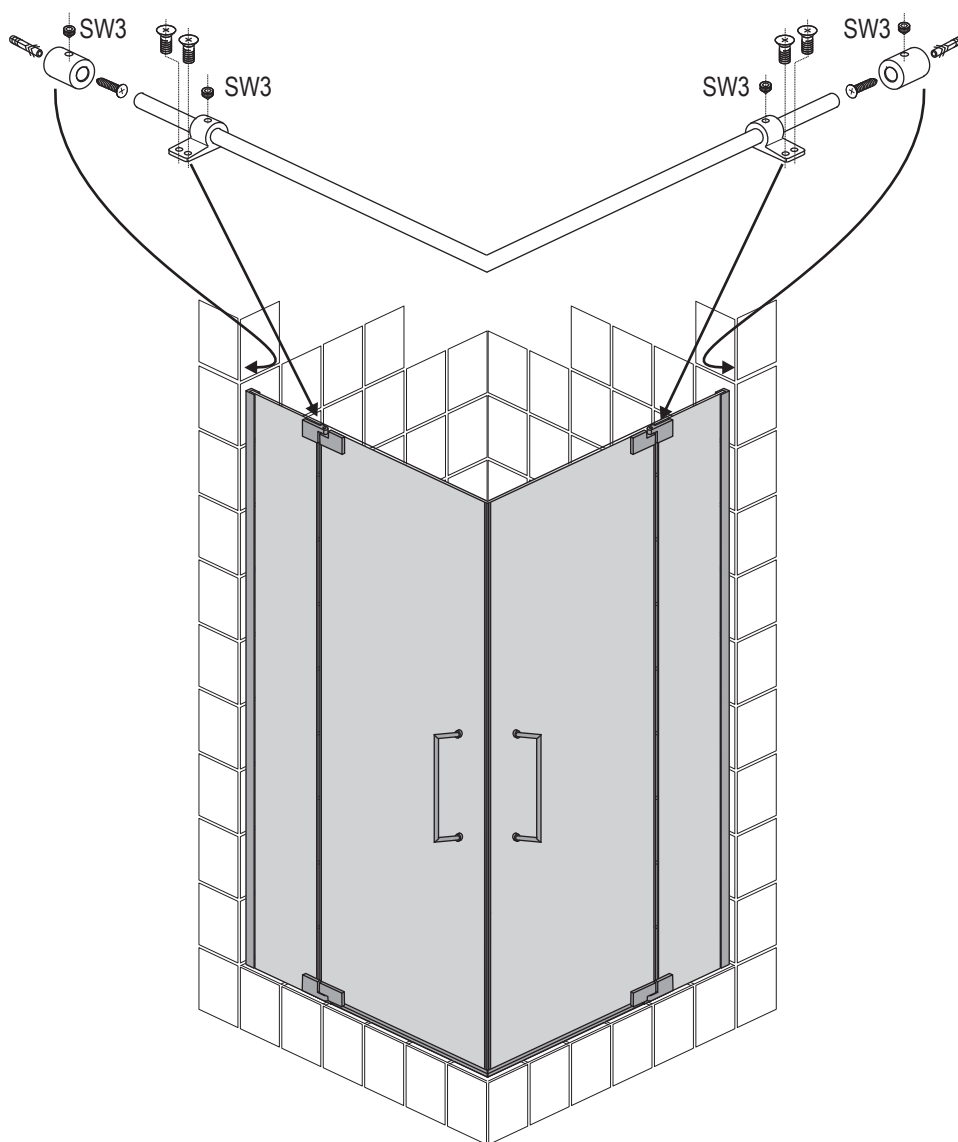

8 x
104790



Für den entsprechenden
Untergrund geeignetes
Silikon verwenden

7

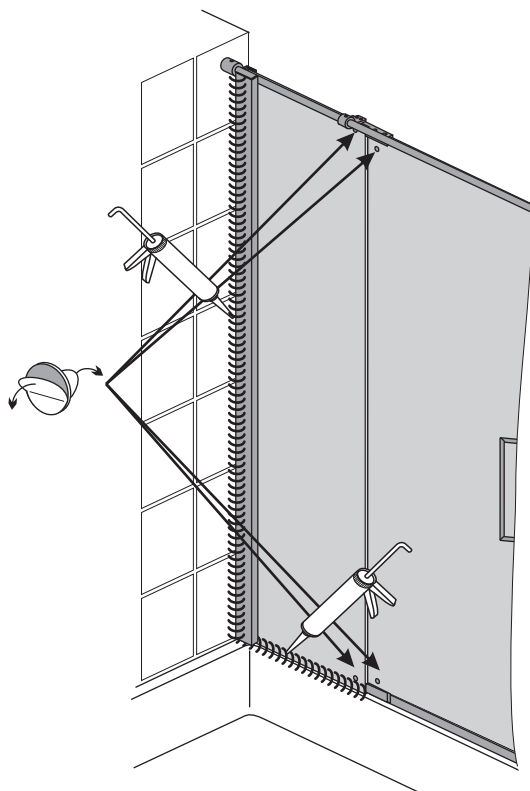
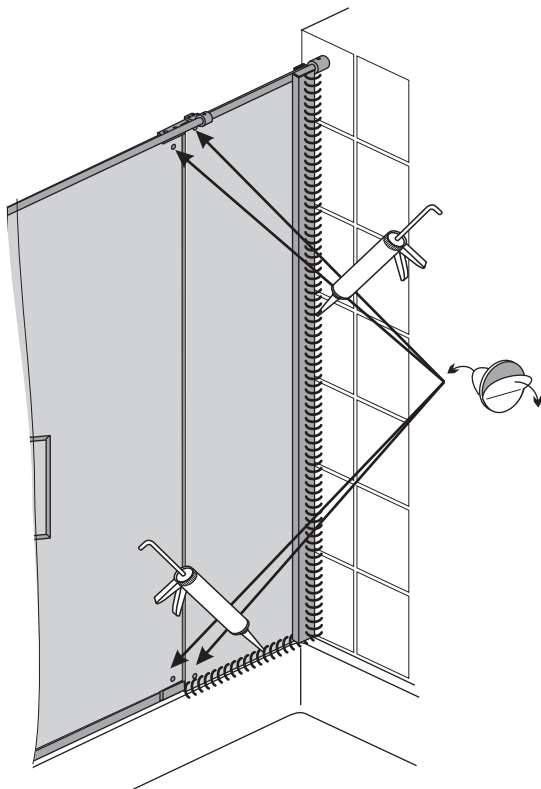

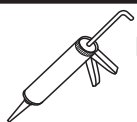

Für den entsprechenden
Untergrund geeignetes
Silikon verwenden

8

