

Ball valve for water for heating systems, full port



DADO ball valve, with female-female threaded connections.
Full port.



➤ Versions and product codes

PRODUCT CODE	CONNECTIONS	FINISHING	HANDLE TYPE	HANDLE COLOR	NOTES
R910X022	G 3/8"F x G 3/8"F	Nickel plated brass	Large lever	Red	DADO ball
R910X023	G 1/2"F x G 1/2"F	Nickel plated brass	Large lever	Red	DADO ball
R910X024	G 3/4"F x G 3/4"F	Nickel plated brass	Large lever	Red	DADO ball
R910X025	G 1"F x G 1"F	Nickel plated brass	Large lever	Red	DADO ball
R910X026	G 1-1/4"F x G 1-1/4"F	Nickel plated brass	Large lever	Red	DADO ball
R910X027	G 1-1/2"F x G 1-1/2"F	Nickel plated brass	Large lever	Red	DADO ball
R910X028	G 2"F x G 2"F	Nickel plated brass	Large lever	Red	DADO ball
R910X029	G 2-1/2"F x G 2-1/2"F	Nickel plated brass	Lever	Red	DADO ball
R910X030	G 3"F x G 3"F	Nickel plated brass	Lever	Red	DADO ball
R910X031	G 4"F x G 4"F	Nickel plated brass	Lever	Red	DADO ball

Technical data

Main features and materials

- Suitable for water for heating/cooling systems, not dangerous gas and liquid hydrocarbons*
- Full port
- Valve made of UNI EN 12165 CW617N nickel plated brass
- Stem with double O-Ring
- Nut with anti-corrosion coating, with guarantee seal and hologram
- Steel lever handle with anti-corrosion treatment and red PVC coating
- DADO ball

* Please consult Giacomini technical support, to check the compatibility of the product with the specific hydrocarbon.

Field of applications

- Min. working temperature: -20 °C with 50 % glycol solutions
- Max. working temperature with dry saturated steam: 185 °C with 1,05 MPa (10,5 bar)
- Max. working pressure at 20 °C with water and not dangerous gas: 4,2 MPa (42 bar) for 3/8", 1/2", 3/4" 3,5 MPa (35 bar) for 1", 1-1/4", 1-1/2", 2" 2,8 MPa (28 bar) for 2-1/2", 3", 4"
- Temperature range with liquid hydrocarbons*: -20÷60 °C
- Max. working pressure at 20 °C with liquid hydrocarbons*: 1,2 MPa (12 bar)

Dimensions and Kv

PRODUCT CODE	DN	A [mm]	I [mm]	B [mm]	J [mm]	C [mm]	H [mm]	Kv
R910X022	10	50	25	47	13	77	wr.21	7
R910X023	15	57	28	53	16	77	wr.25	13,3
R910X024	20	62	31	70	21	95	wr.32	25,8
R910X025	25	76	38	78	25	95	wr.39	50,9
R910X026	32	86	43	88	30	95	wr.47	103
R910X027	40	97	48	109	37	137	wr.54	147
R910X028	50	111	55	125	46	137	wr.67	222
R910X029	65	153	76	170	58	187	wr.82	336
R910X030	80	173	87	189	68	187	wr.96	377
R910X031	100	217	108	242	88	257	wr.126	645

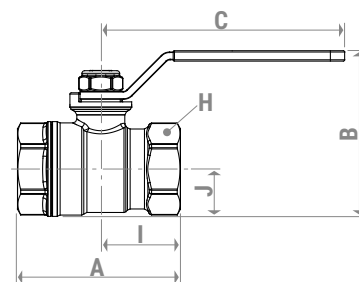

Product specifications

R910

DADO ball valve, with female-female threaded connections. Suitable for water for heating/cooling systems, not dangerous gas and liquid hydrocarbons. Valve made of UNI EN 12165 CW617N nickel plated brass. Full port. Steel lever handle with anti-corrosion treatment and red PVC coating. Stem with double O-Ring. Nut with anti-corrosion coating, with guarantee seal and hologram. Min. working temperature: -20 °C with 50 % glycol solutions. Max. working temperature with dry saturated steam: 185 °C with 1,05 MPa (10,5 bar). Max. working pressure at 20 °C with water and not dangerous gas: 4,2 MPa (42 bar) for 3/8", 1/2", 3/4"; 3,5 MPa (35 bar) for 1", 1-1/4", 1-1/2", 2"; 2,8 MPa (28 bar) for 2-1/2", 3", 4". Temperature range with liquid hydrocarbons: -20÷60 °C. Max. working pressure at 20 °C with liquid hydrocarbons: 1,2 MPa (12 bar).

⚠ Safety Warning. Installation, commissioning and periodical maintenance of the product must be carried out by qualified operators in compliance with national regulations and/or local standards. A qualified installer must take all required measures, including use of Individual Protection Devices, for his and others' safety. An improper installation may damage people, animals or objects towards which Giacomini S.p.A. may not be held liable.

♻ Package Disposal. Carton boxes: paper recycling. Plastic bags and bubble wrap: plastic recycling.

ℹ Additional information. For more information, go to giacomini.com or contact our technical assistance service. This document provides only general indications. Giacomini S.p.A. may change at any time, without notice and for technical or commercial reasons, the items included herewith. The information included in this technical sheet do not exempt the user from strictly complying with the rules and good practice standards in force.

♻ Product Disposal. Do not dispose of product as municipal waste at the end of its life cycle. Dispose of product at a special recycling platform managed by local authorities or at retailers providing this type of service.