

# Geberit Montage

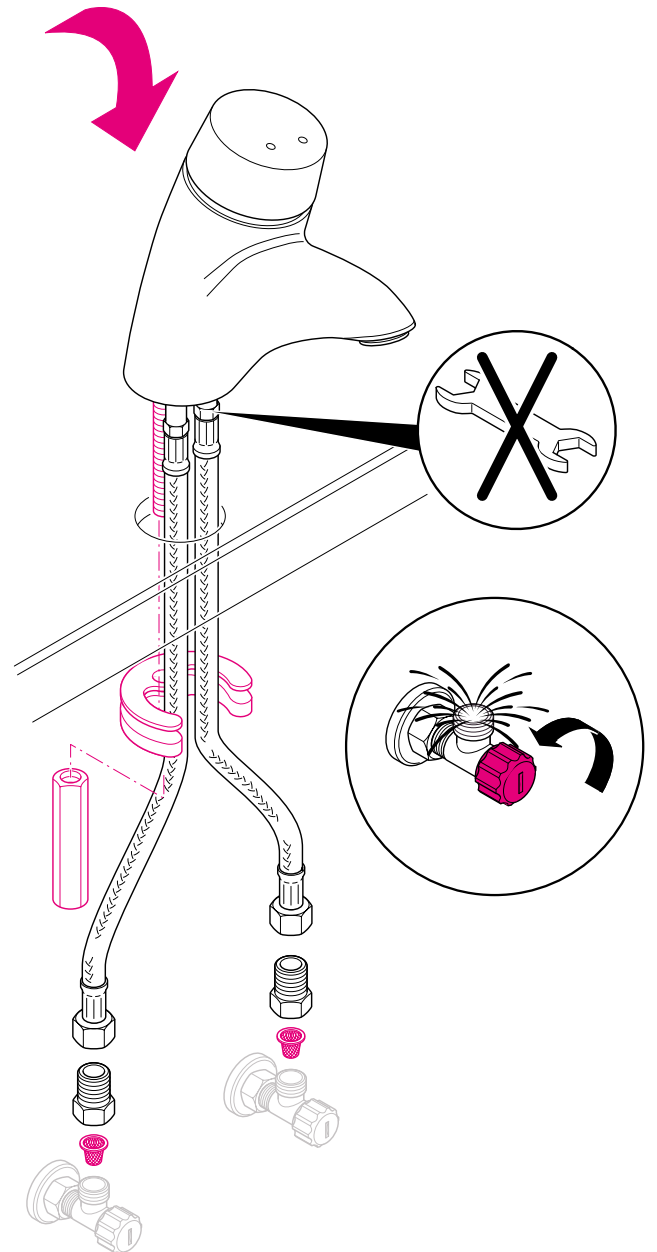
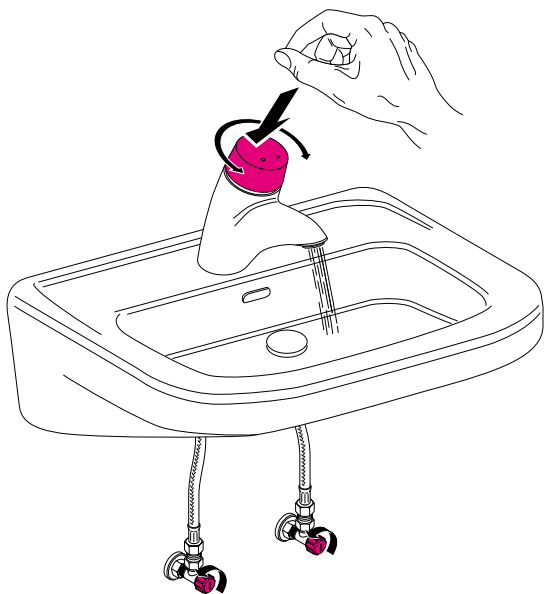
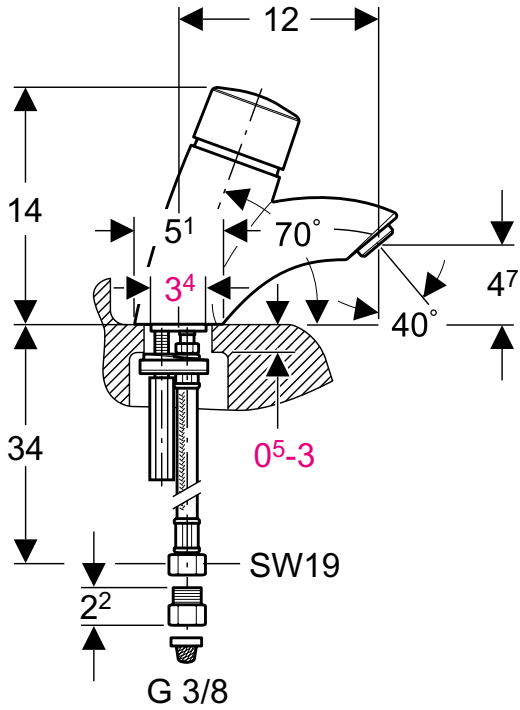

int. 9396-01

994.957.00.0

**■ GEBERIT**

# Geberit Service

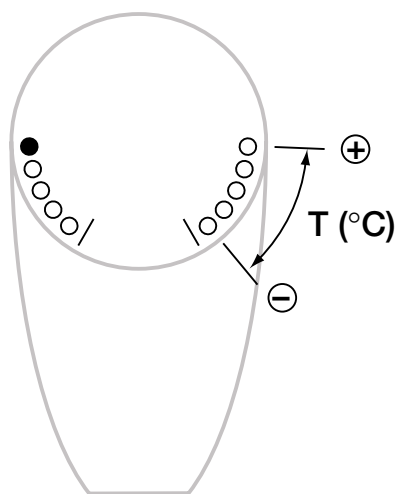
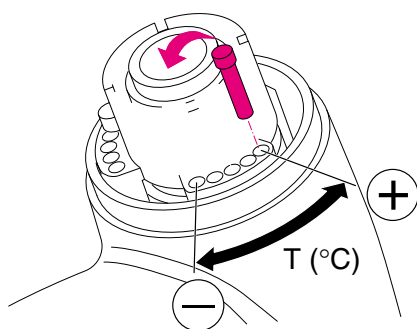
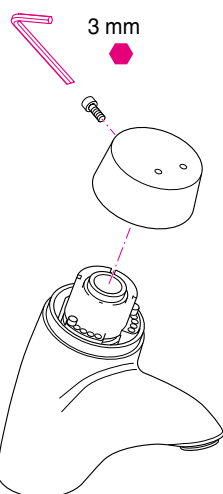
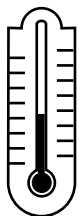

**DE** Temperatur (T) zu hoch oder zu niedrig → Temperaturbegrenzung einstellen

**FR** Température (T) trop élevée ou trop basse → régler la limitation de température

**IT** La temperatura (T) è troppo alta o troppo bassa → regolare il limitatore della temperatura

**GB** Temperature (T) is too high or too low → adjust temperature limitation

**NL** Temperatuur (T) te hoog of te laag → Temperatuur begrenzer instellen

**ES** La temperatura (T) es demasiado alta o baja → ajustar la banda de temperatura

**PT** A temperatura (T) está muito alta ou muito baixa → ajustar o limitador de temperatura

**PL** Temperatura (T) za wysoka lub za niska → Ustawić ogranicznik temperatury

**SI** Temperatura (T) je previsoka ali prenizka → Nastaviti mešalec temperature

**HR** Temperatura (T) je previsoka ili preniska → Podesiti regulator temperature

# Geberit Service



3 mm

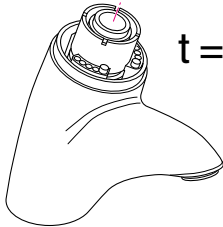
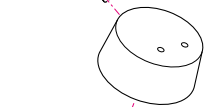

t = (8) [sec]

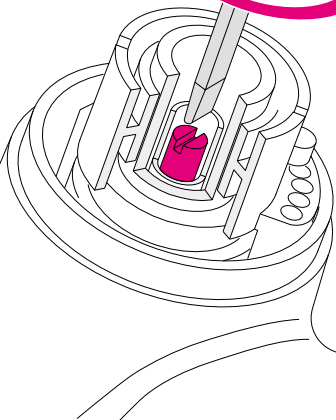
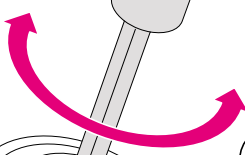

**DE** Laufzeit (t) zu lang oder zu kurz → Zeitdauer einstellen

**FR** Durée d'écoulement (t) trop longue ou trop courte → régler la durée d'écoulement

**IT** La durata dell'erogazione (t) è troppo lunga o corta → regolare il tempo

**GB** Flow duration (t) is too long or too short → adjust time setting

**NL** Looptijd (t) te lang of te kort → Tijdsduur instellen

**ES** El tiempo de operación (t) es demasiado largo o corto → ajustar el tiempo de la operación

**PT** A duração da descarga (t) é demasiado longa ou demasiado breve → regular o temporizador

**PL** Czas wypływu (t) za długi lub za krótki → Ustawić czas wypływu

**SI** Čas iztoka (t) je predolg ali prekratek → Nastaviti čas iztoka

**HR** Vrijeme istjecanja (t) je predugo ili prekratko → Podesiti vrijeme istjecanja

# Geberit Service

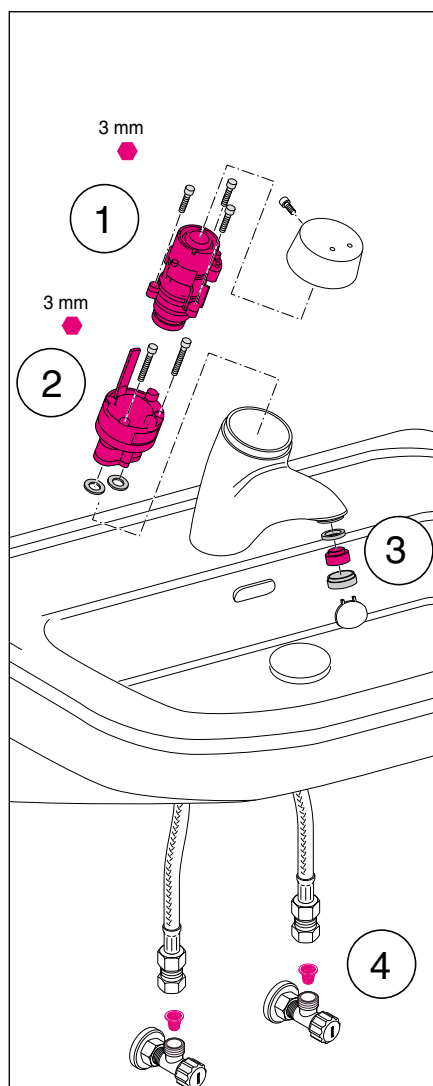

**DE** Armatur tropft oder Wasser fließt nicht oder Wasser stoppt nicht  
→ Patronen wechseln ①  
Temperatur kann nicht reguliert werden → Mischer wechseln ②  
Wassermenge ist zu gering → Perlator und Filter reinigen ③④

**FR** Robinet goutte ou l'eau ne s'arrête pas → échanger la cartouche ①  
La température ne peut pas être ajustée → échanger la cartouche de mitigeur ②  
Le débit est insuffisant → nettoyer l'aérateur et les filtres ③④

**IT** La rubinetteria gocciola o l'acqua non scorre o non è possibile arrestare l'erogazione dell'acqua → sostituire la cartuccia ①  
Non è possibile regolare la temperatura → cambiare il miscelatore ②  
La quantità d'acqua non è sufficiente → pulire il rompiegetto e i filtri ③④

**GB** Mixer drips, water does not flow or does not shut off → change cartridge ①  
Temperature can not be adjusted → change mixer cartridge ②  
Water flow is insufficient → clean aerator and filters ③④

**NL** De kraan geeft geen water, de kraan sluit niet, of de kraan druppelt  
→ Stuurpatroon vervangen ①  
Temperatuur kan niet ingesteld worden → Mengpatroon vervangen ②  
Waterhoeveelheid te gering → Perlator en filter reinigen ③④

**ES** Gotea el mezclador, no sale agua o no cierra → cambiar el cartucho ①  
No se puede ajustar la temperatura → cambiar el cartucho del mezclador ②  
Insuficiente flujo de agua → limpiar los aireadores y filtros ③④

**PT** A misturadora pinga, não corre água ou a água não pára de correr  
→ mudar o cartuxo ①  
Não é possível ajustar a temperatura → mudar o cartuxo misturador ②  
O caudal de descarga não é suficiente → limpar o perlador e o filtro ③④

**PL** Woda kapie z wylewki albo woda nie płynie albo woda płynie bez przerwy → Wymienić wkład ①  
Nie można wyregulować temperatury → Wymienić mieszacz ②  
Strumień wody niewystarczający → Wyczyścić perlator i filtr ③④

**SI** Voda kaplja, ne teče ali se ne ustavi → Zamenjati kartušo ①  
Temperatura se ne more uravnati → Zamenjati mešalec ②  
Količina vode je premala → Očistiti perlator in filter ③④

**HR** Voda kapa, ne istječe ili se ne zaustavlja istjecanje  
→ Izmijeniti kartušu ①  
Temperaturu nije moguće regulirati → Izmijeniti mješac ②  
Količina vode je premala → Očistiti perlator i filter ③④