

Montageanleitung Assembly Instructions V117.6

**Schiebetür 2-teilig mit Seitenteil (ST)
und Seitenteil kurz (STK) „Pro in und auf Fliese“/
2-part sliding door with side panel (ST)
and side panel short (STK) „Pro on and in tiling“**

**Typ 1:
Auf Fliesen /
On tiles**

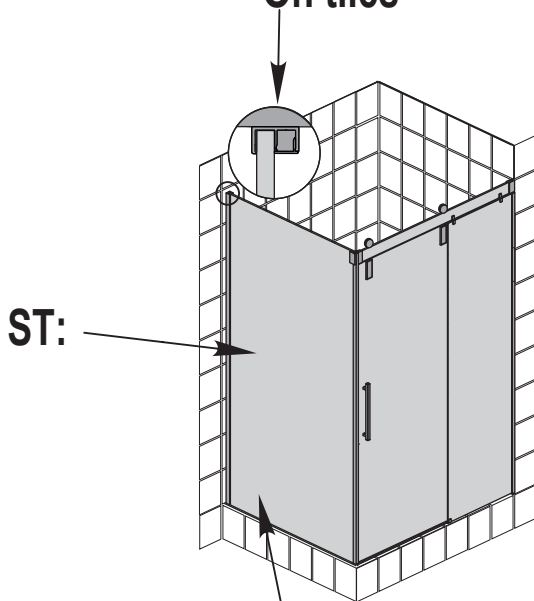

SL: Seitenteil links, dargestellt / side panel left, shown
(SR: Seitenteil rechts, gespiegelt / side panel right, mirrored)

**Typ 2:
In Fliesen /
In tiles**

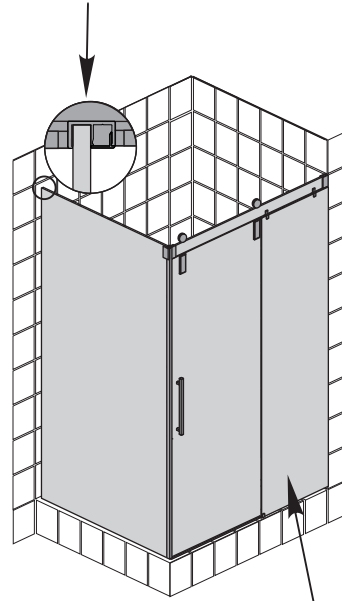

FR: Fixteil rechts, dargestellt / Fixed part right, shown
(FL: Fixteil links, gespiegelt / Fixed part left, mirrored)

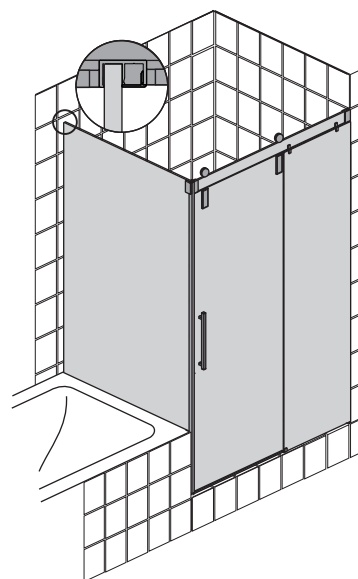
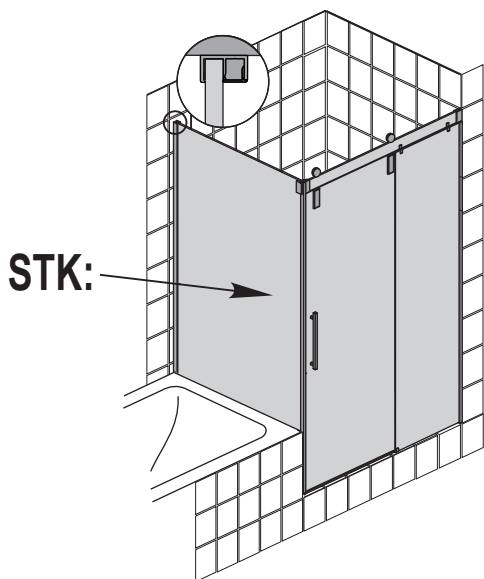

Vor Gebrauch sorgfältig lesen!
Read carefully before use!

Diese Unterlage ist für den Endkunden!
This document is for the end customer!

Typ 1
 1 x 106316
 4 x ø6 106537
 4 x ø4,2x50 106538
 4 x M4 101385

4 x ø6 106537
 3 x 104354

3 x 106318 +106319
 1 x 106341

1

Typ 1

1.2

1.1



Übrig bleibende Montagebauteile möglich. /
 Remaining assembly components possible.

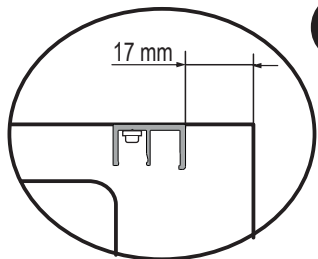
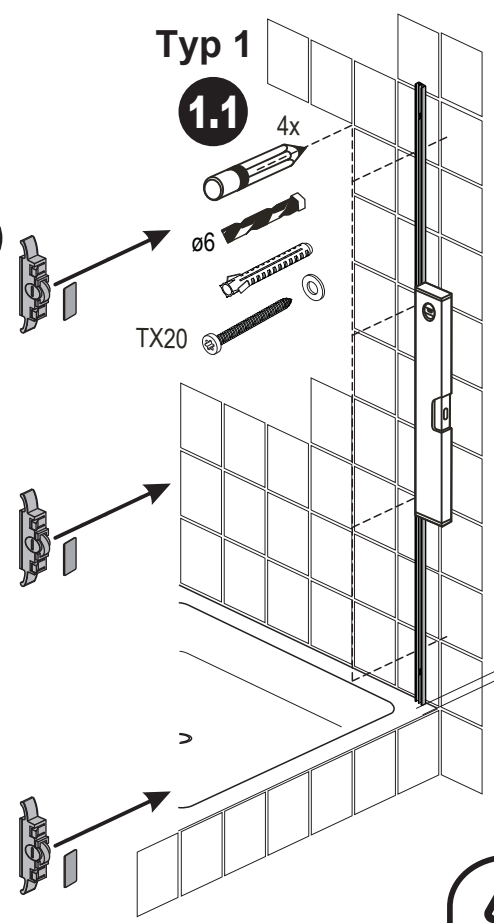

1.1

Bei Typ 2 schon vormontiert! /
 Pre-assembled in type 2!

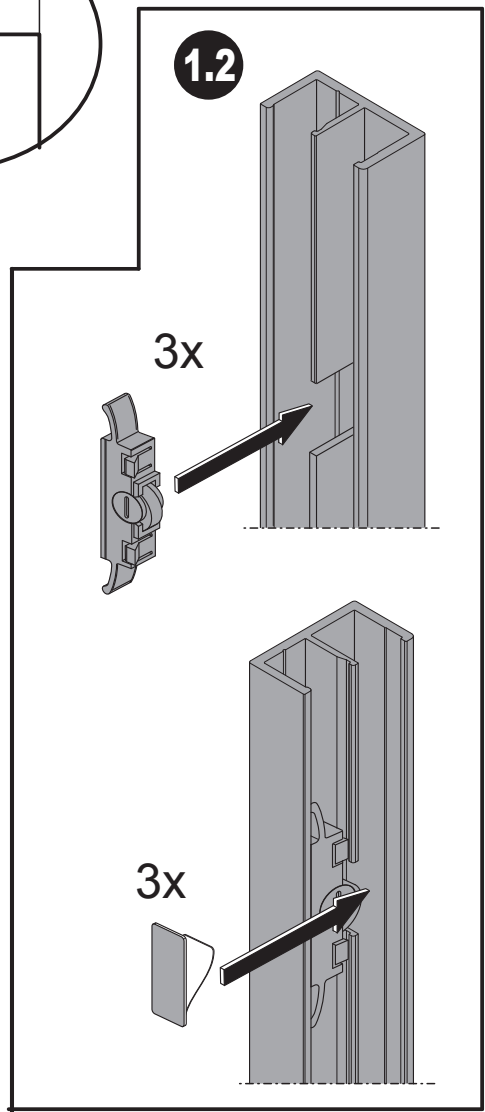
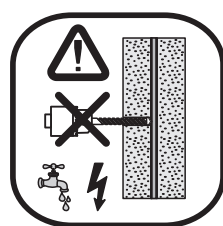

1.3

4x ø6
 ø 6mm

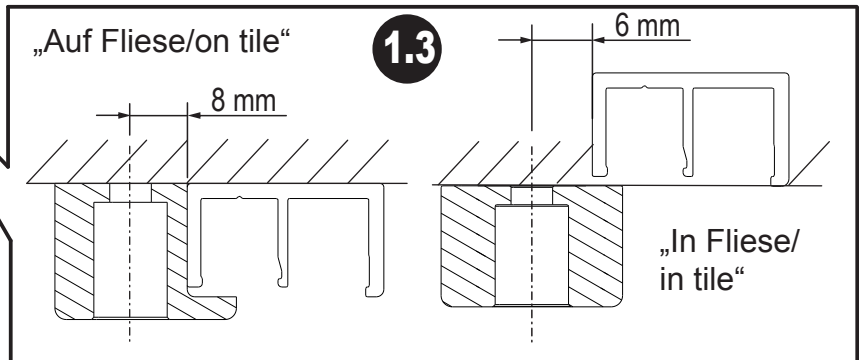
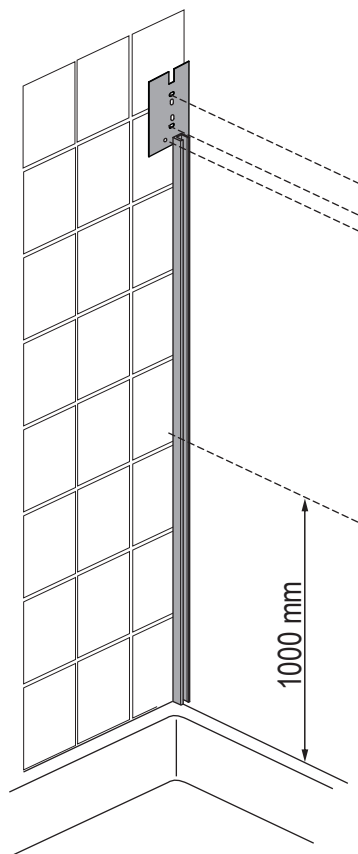

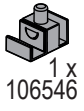

1 x
106546

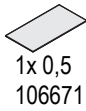

1 x 0,5
106671

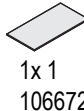

1 x 1
106672

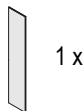

1 x

2

2.5

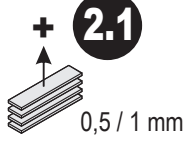
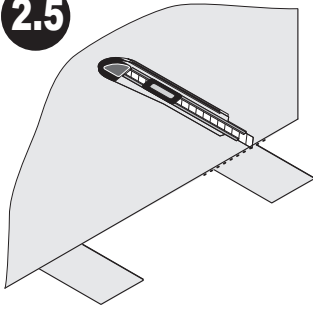

2.3

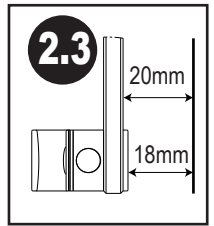

2.3

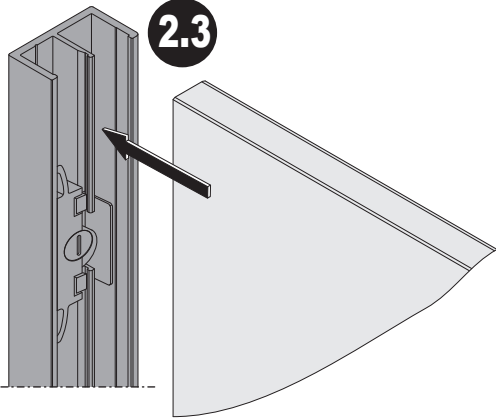

2.4

3x

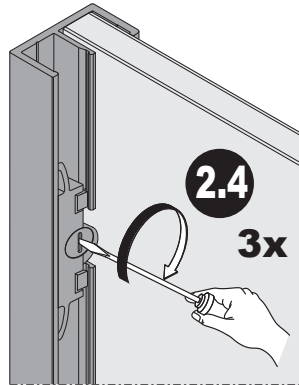

2.2

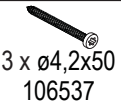
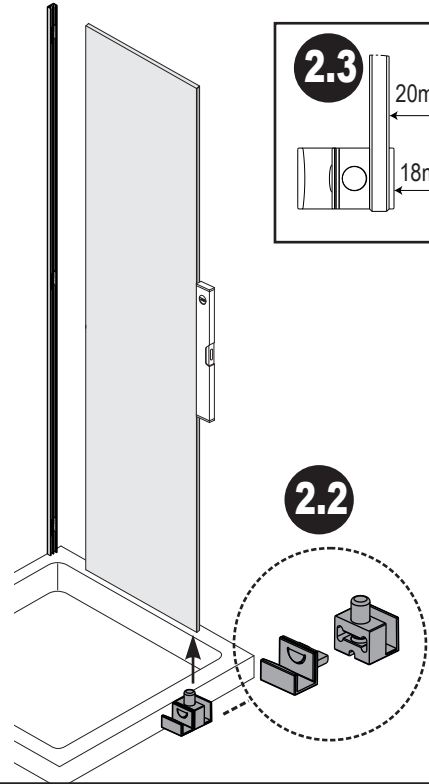

3 x $\varnothing 4,2 \times 50$
106537



3 x M4
101385

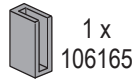

1 x
106165



1 x
106178



1 x
105269

3

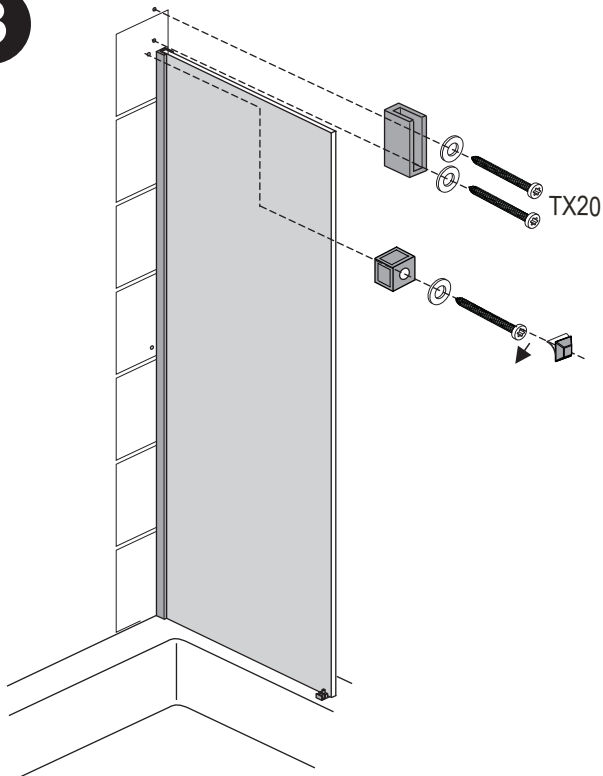

Typ 1

- 1 x 106316
- 4 x ø6 106537
- 4 x ø4,2x50 106538
- 4 x M4 101385

- 4 x ø6 106537
- 3 x 104354

- 3 x 106318 +106319

4

ST:



Übrig bleibende Montagebauteile möglich. / Remaining assembly components possible.

Typ 1

Bei Typ 2 schon vormontiert! / Pre-assembled in type 2!

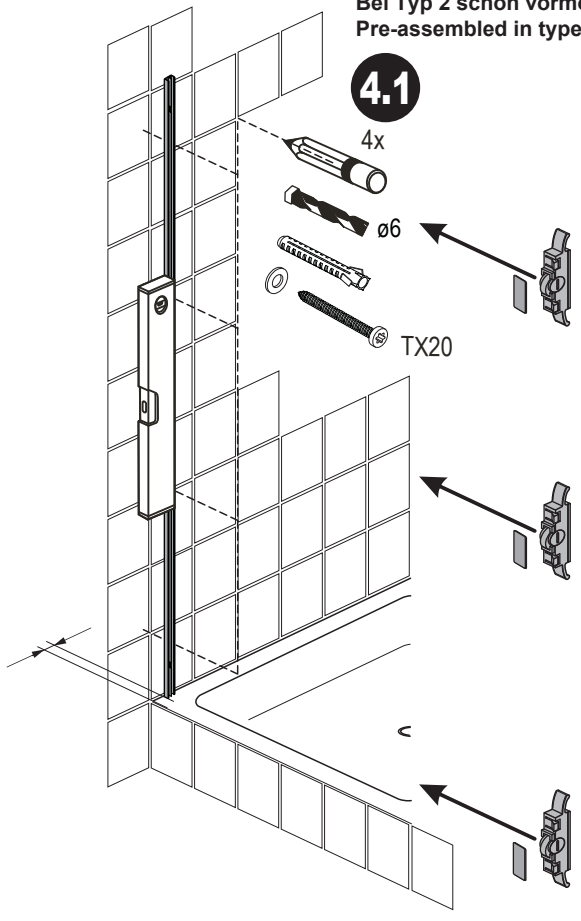

4.1

- 4x
- ø6
- TX20

4.2

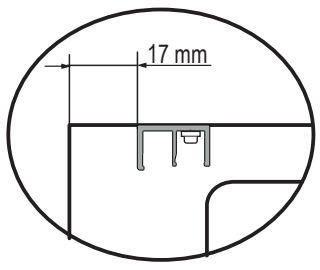

Duschwanne/
Shower tray

4.2

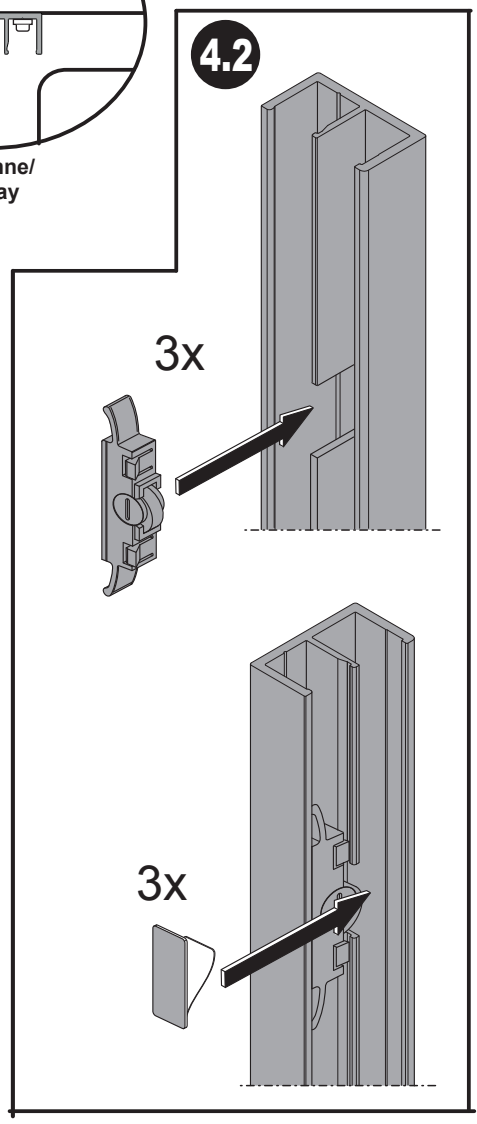

3x

3x

STK:

Typ 1

Bei Typ 2 schon vormontiert! / Pre-assembled in type 2!

- 4x 1
- ø6
- TX20

4.2

3x

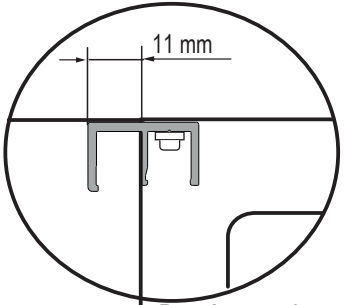
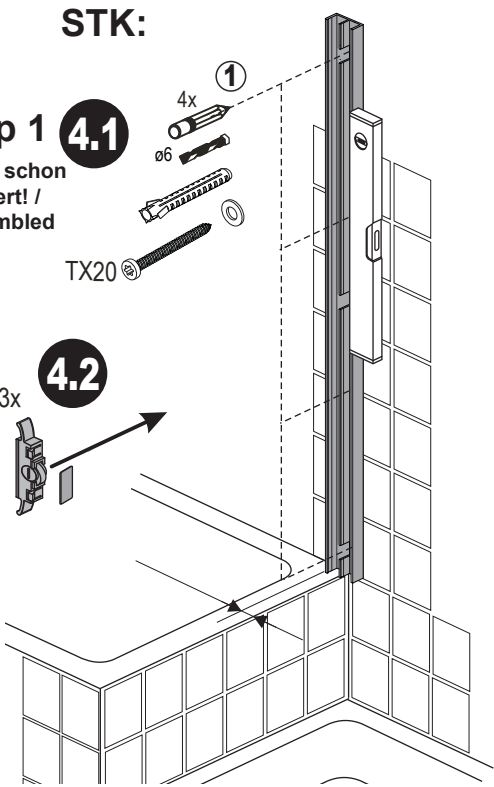

Badewanne/
Bathtub | Duschwanne/
Shower tray

1x 0,5
106671

1x 1
106672

1x

Typ 1
SL: 1 x 106647
(SR: 1 x 106648)

STK:
2 x ø6 106537 2 x ø4,2x50 106538 2 x M4 101385 1 x 104949

5 ST:

5.5 Typ 1

3x 5.4

5.2

5.3

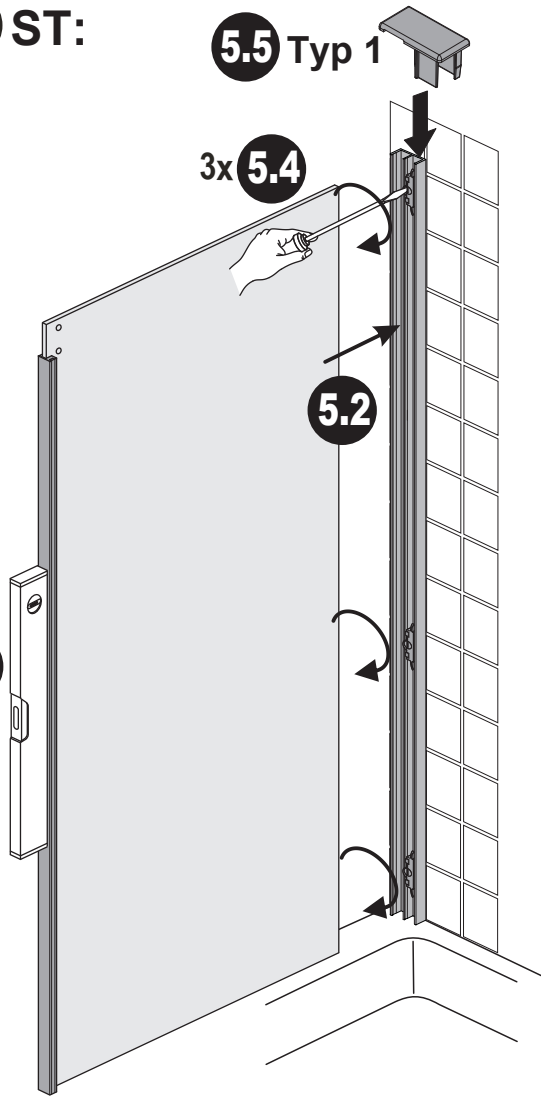

5 STK:

5.5 Typ 1

3x 5.4

5.2

5.3

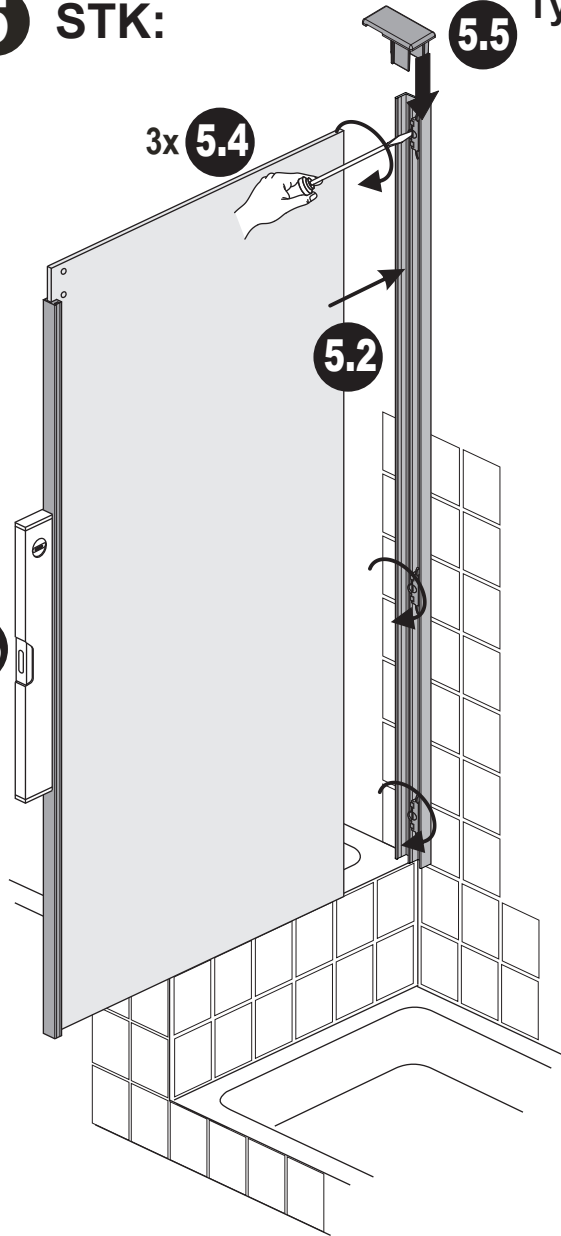

ST&STK:

5.6

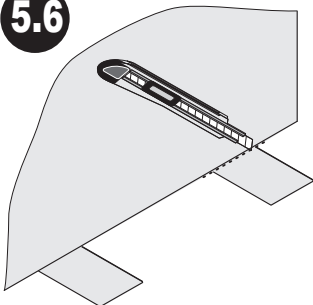

+ 5.1
0,5 / 1 mm

5.7

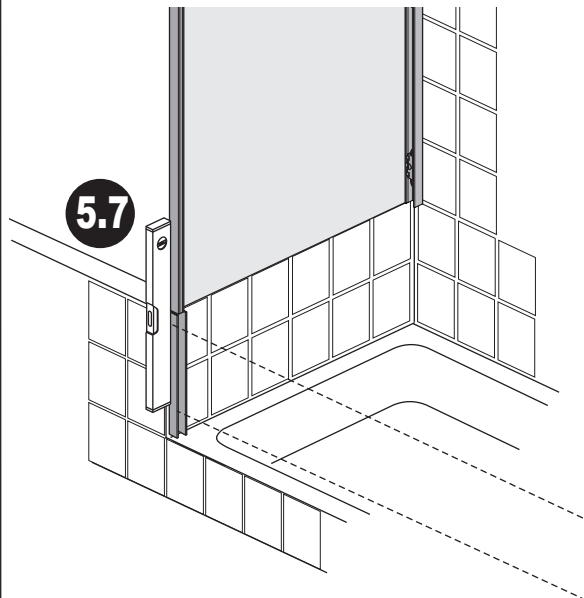

5.8

2x
ø6
TX20

1 x
104947

3 x M6x6
105946

3 x
103637

5 STK:

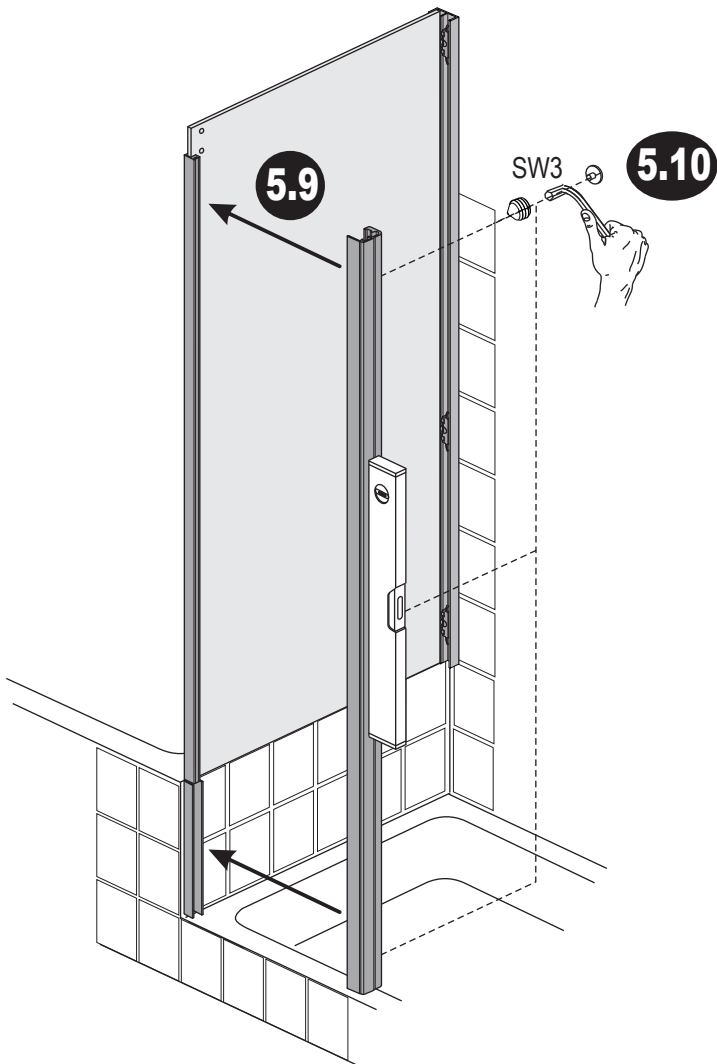

- 4 x M6x18 102096
- 2 x M6x16 100992
- 2 x 106206
- 6 x 102408
- 2 x 106207
- 1 x 102434
- 2 x 105308
- 6 x 103674
- 1 x 102116

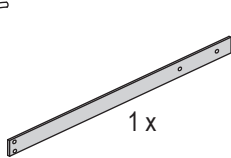

Für den entsprechenden Untergrund geeignetes Silikon verwenden.
 Oberfläche vor dem Silikonieren gründlich reinigen (fettfrei).
 Use suitable silicone for the respective base material.
 Thoroughly clean the surface prior to using silicone.

6

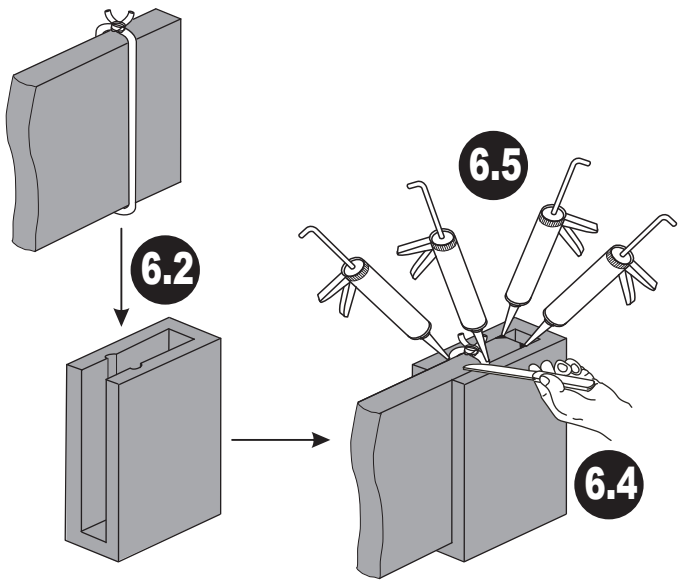
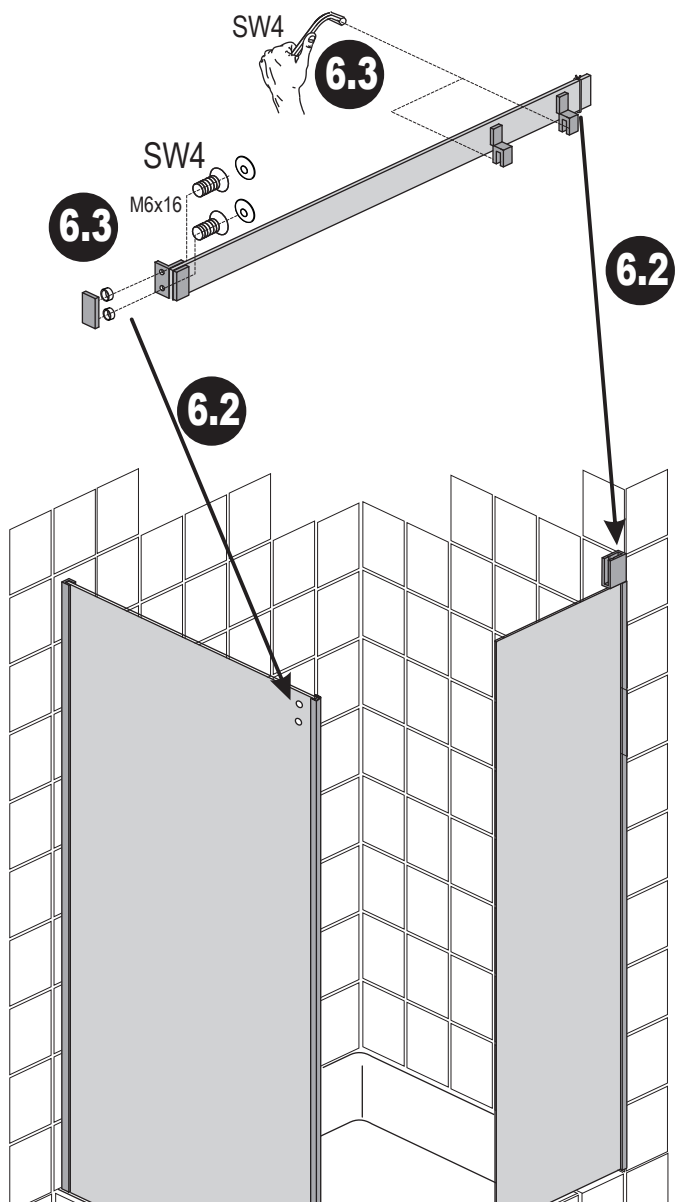
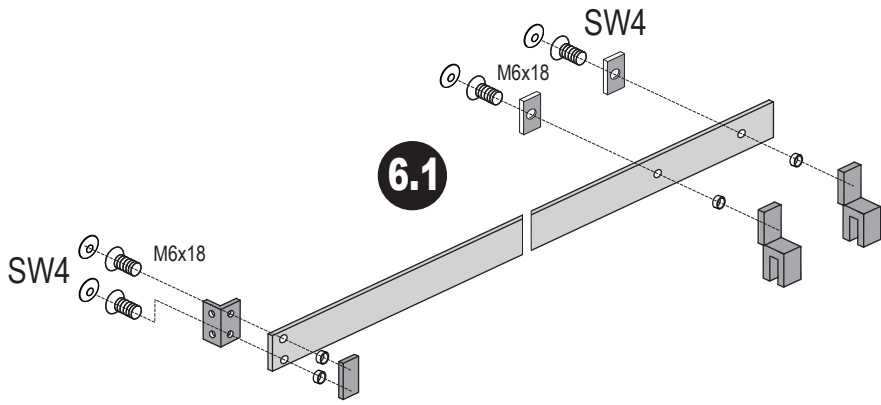

1 x
104836

2 x
106170

2 x
106169

1 x

4 x M6x22
106293

4 x
102408

4 x
103674

1 x
106343

1 x
106342

1 x
107200

7

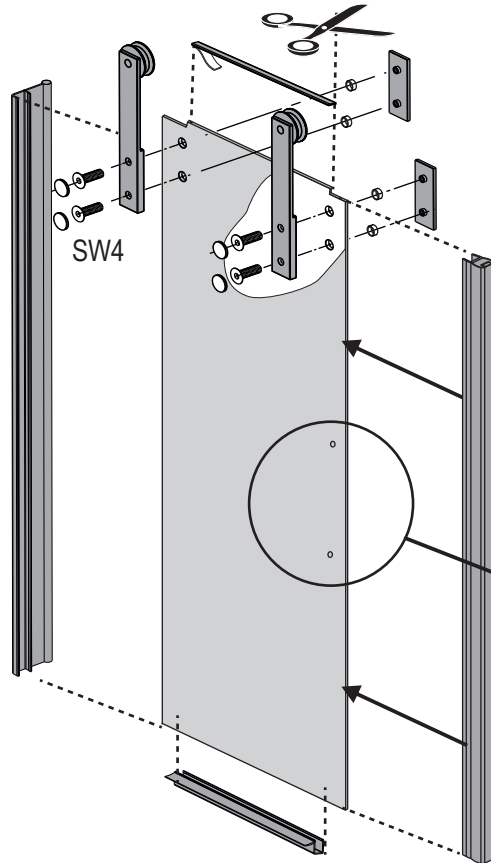

Oberkante Glas muss immer geschützt sein! Bruchgefahr!!! / Upper glass edge need to be covered always! Risk of breaking!!!



Rollenhalter in regelmäßigen Abständen kontrollieren !!! / Check roller holders at regular intervals !!!

8

Griffmontage / Handle mounting

9

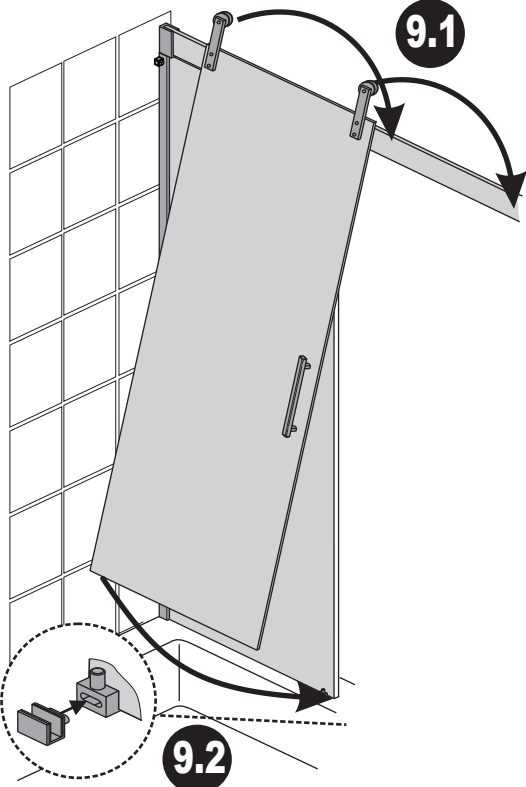

10 ST:

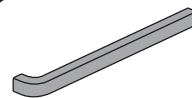

FR: 1x 103813 R
(FL: 1x 103813 L)

OPTION

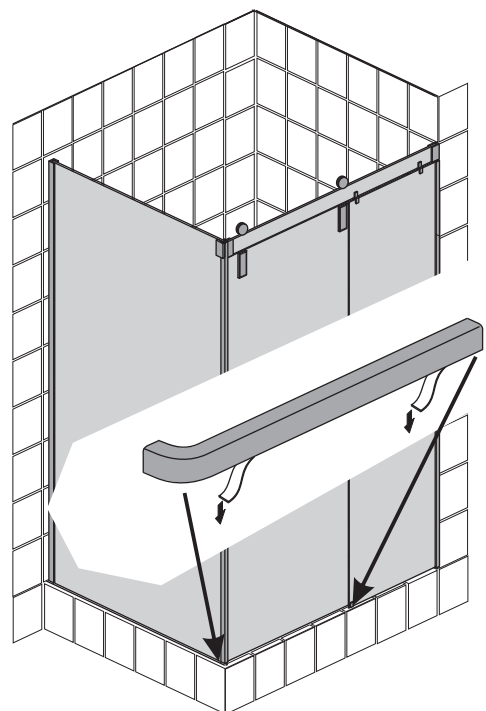

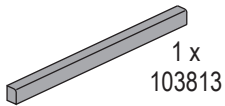

OPTION

10 STK:

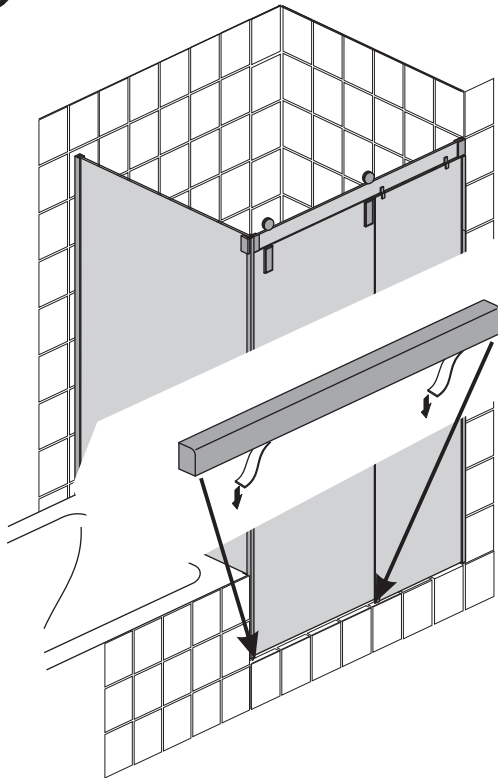

1 x 106317

„PRO“ Auf Fliese / on tiles

Typ1



1 x
106469

„PRO“ In Fliese / in tiles

Typ2



1 x
106178



1 x $\varnothing 4,2 \times 50$
106538



1 x M4
101385



1 x
106217

Für den entsprechenden Untergrund geeignetes Silikon verwenden.
Oberfläche vor dem Silikonieren gründlich reinigen (fettfrei).
Use suitable silicone for the respective base material.
Thoroughly clean the surface prior to using silicone.

11

11.1

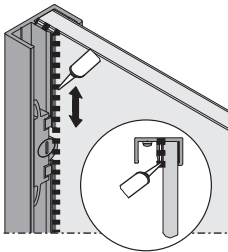

11.2

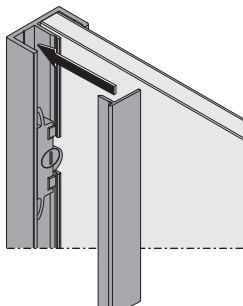

11.3

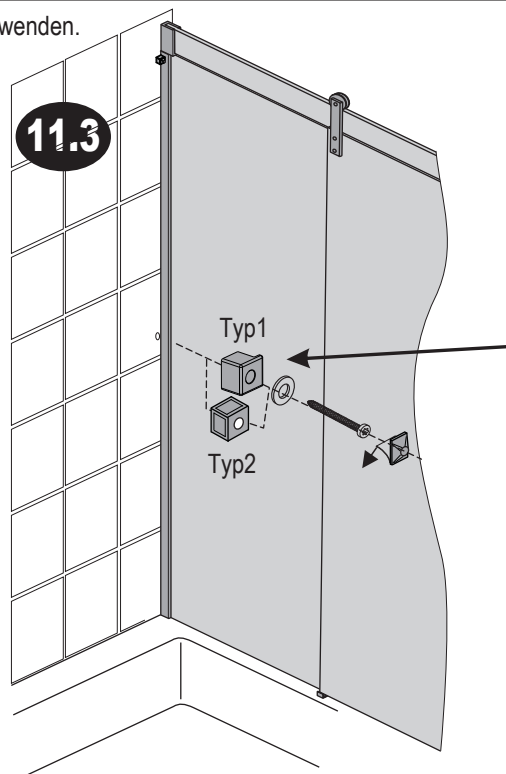

Klebefläche
muss staub- &
fettfrei sein ! /
Glue surface
must be free
from dust and
grease!



12

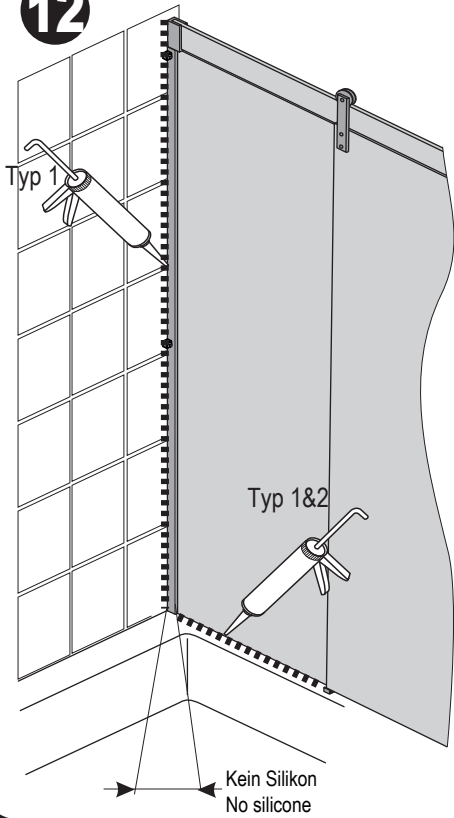

Für den entsprechenden Untergrund geeignetes Silikon verwenden.
 Oberfläche vor dem Silikonieren gründlich reinigen (fettfrei).
 Use suitable silicone for the respective base material.
 Thoroughly clean the surface prior to using silicone.



13

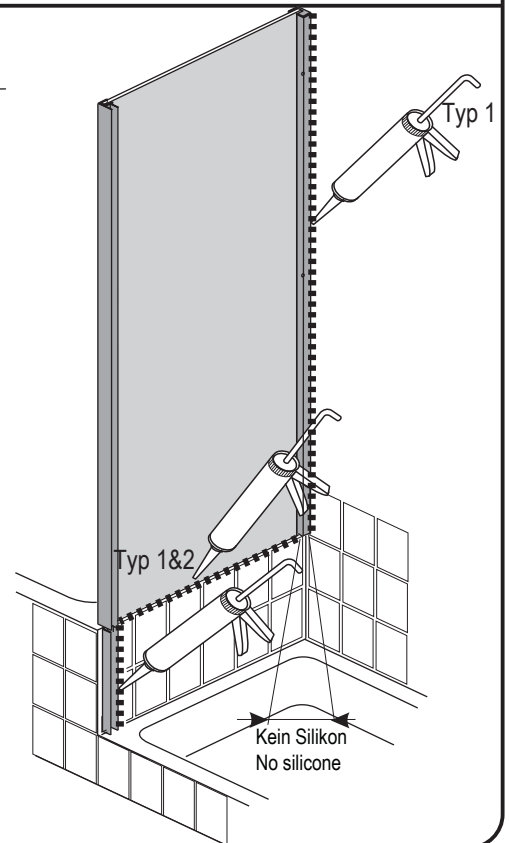
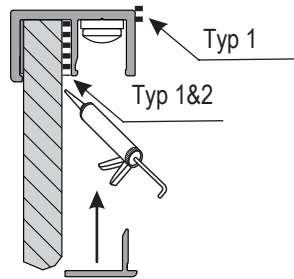
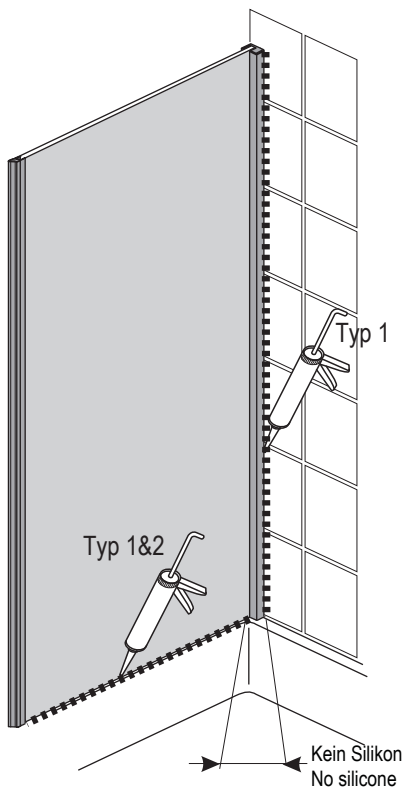



Für den entsprechenden Untergrund geeignetes Silikon verwenden.
Oberfläche vor dem Silikonieren gründlich reinigen (fettfrei).
Use suitable silicone for the respective base material.
Thoroughly clean the surface prior to using silicone.

14

ST:

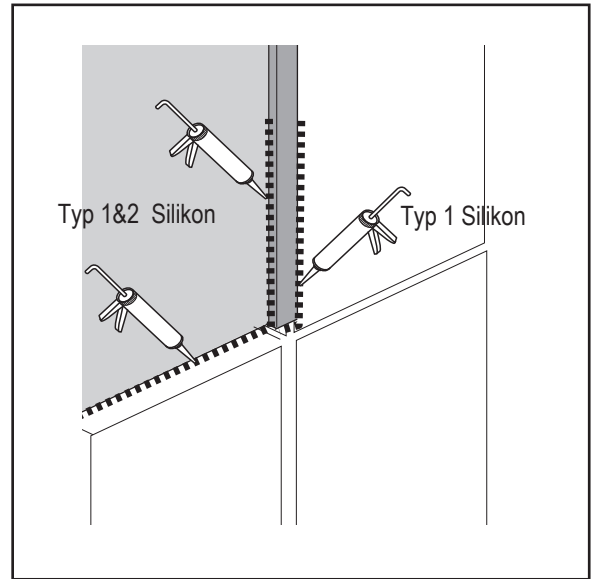
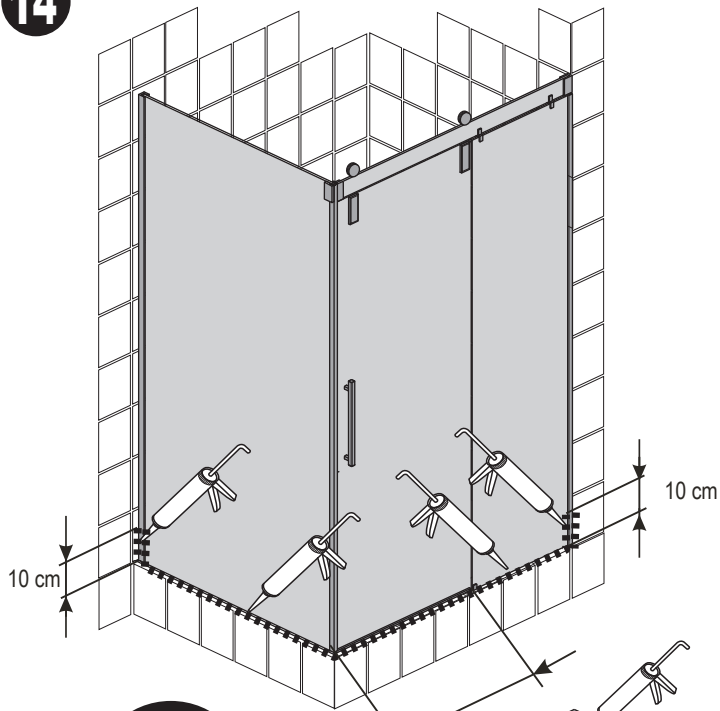

OPTION

STK:

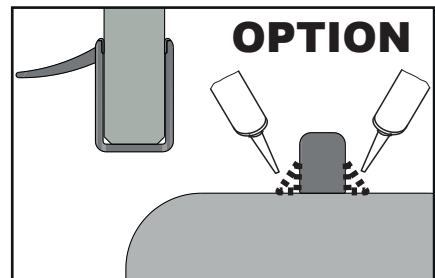
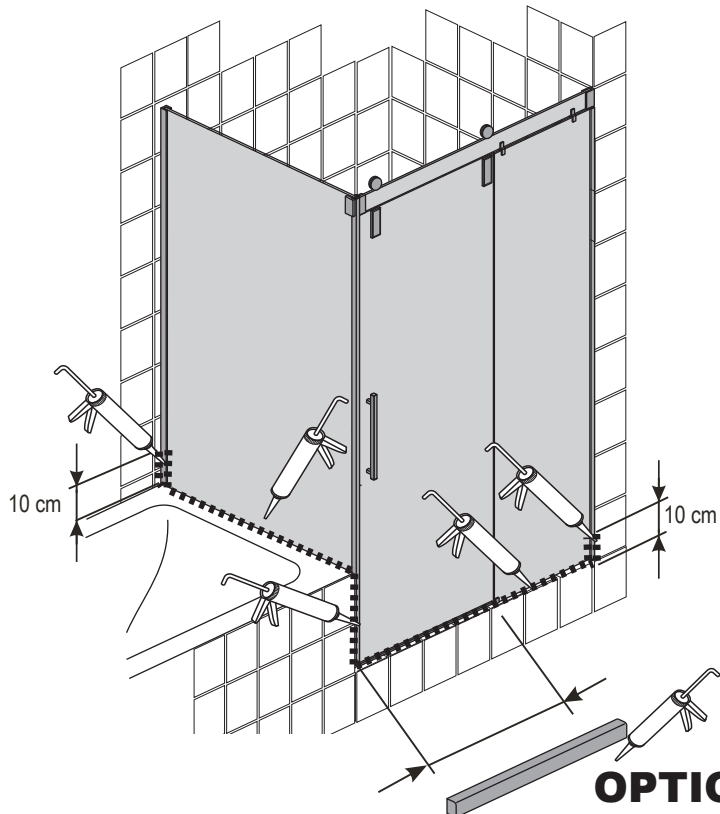

OPTION