

# EckEinstieg 4-teilig

4-part corner entry

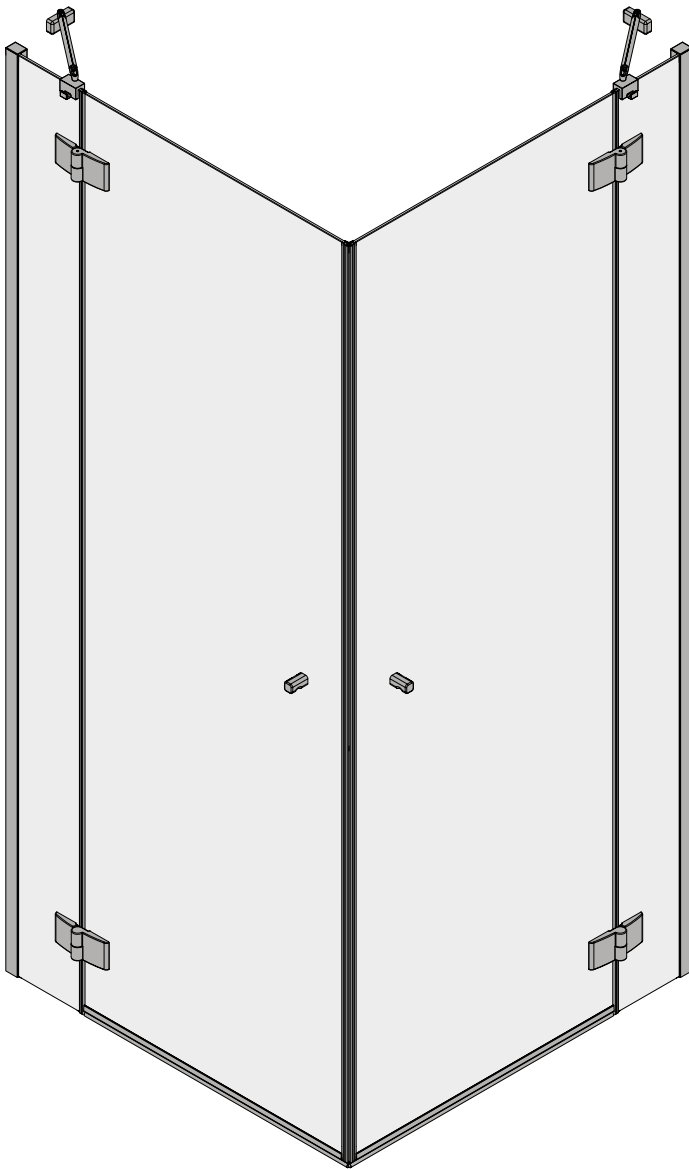

**Montageanleitung D074.1**  
Assembly Instruction D074.1

**1 Vario**

2 x 106869

1 x 106870 +  
1 x 106871

6 x 104354

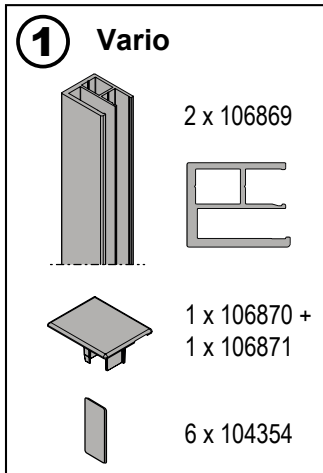

**Pro**

2 x 106707

1 x 106708 +  
1 x 106709

6 x 106734

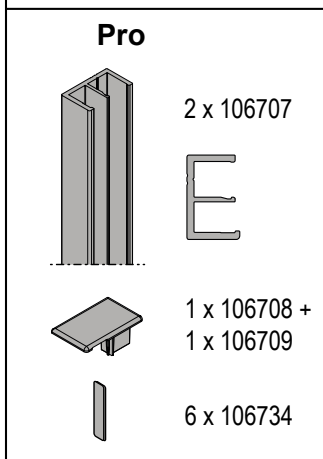

**Vario + Pro**

8 x  $\varnothing 6 \times 50$   
106537

8 x  $\varnothing 4,2 \times 50$   
106538

8 x 101385

6 x 106318 +  
6 x 106319

2 x 106317

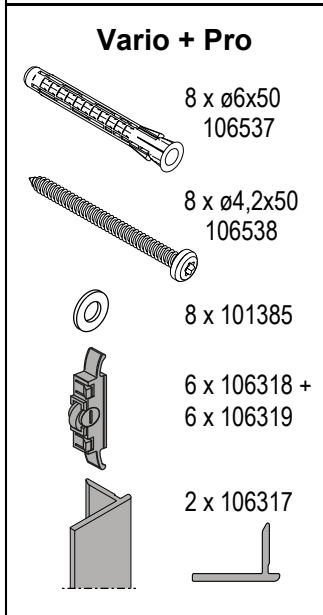

**1**

2 x kpl.

4 x 103270

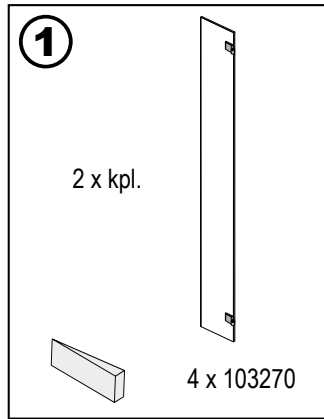

**1 Zero**

2 x kpl.

4 x 103270

4 x 105832

4 x 105922

8 x  $\varnothing 6 \times 50$   
106537

8 x  $\varnothing 4,8 \times 60$   
106882

8 x 103967

4 x 103970

4 x 105545

4 x M8x10  
105818

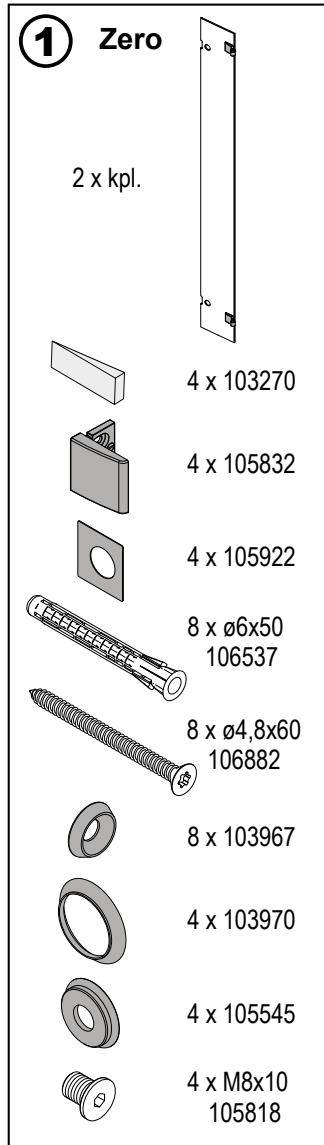

**2**

2 x kpl.

2 x 105959

1 x 105837 +  
1 x 105838

2 x 102117

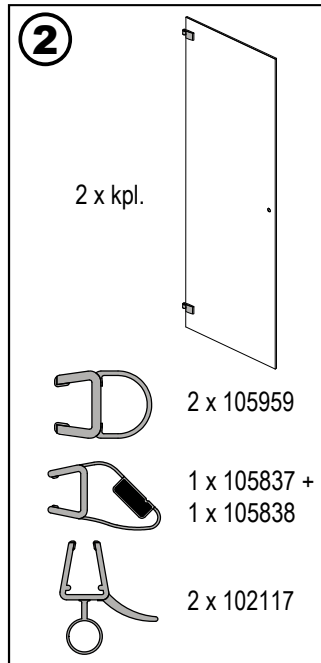

**3**

2 x Griff kpl.

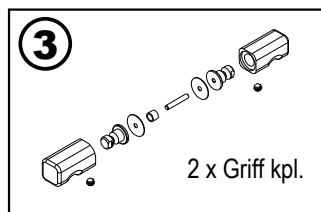

**4**

2 x 104362

4 x  $\varnothing 6 \times 50$   
106537

4 x  $\varnothing 4,2 \times 50$   
106538

4 x 101556

2 x 101548

2 x 101547

2 x 104386

4 x 104404

4 x  $\varnothing 4,2 \times 13$   
106620

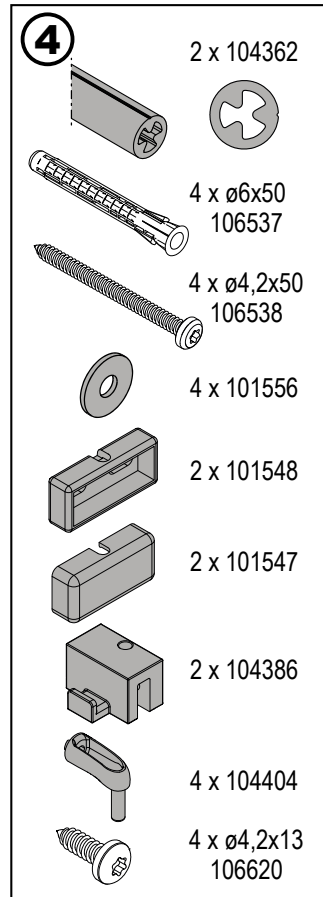

**5 Option**

2 x 100636

2 x 104242

1 x 106384

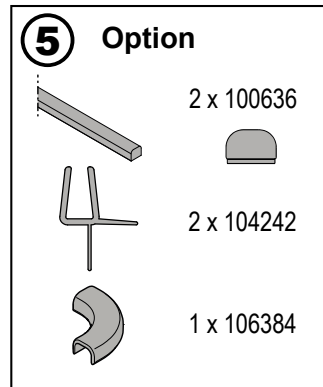

**6 Vario + Pro**

8 x 104790

**Zero**

4 x 101509

12 x 104790

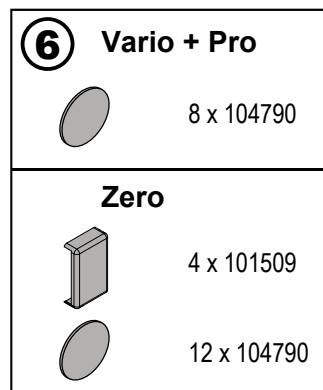

**Achtung:**  
Montagepaket kann mehr Teile enthalten, als zum Aufbau benötigt werden.  
Possibly more assembly components are included than necessary.

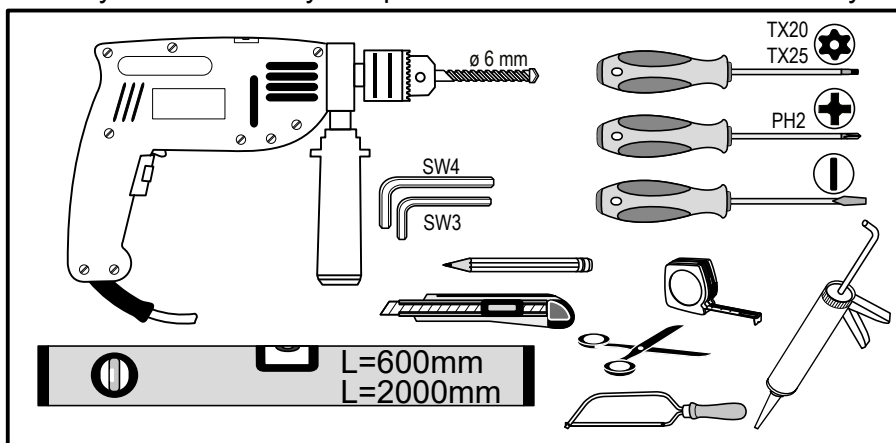



Bei allen Arbeitsschritten mit dem Silikon-Symbol: Für den entsprechenden Untergrund geeignetes Silikon verwenden. Oberfläche vor dem Silikonieren gründlich reinigen (fettfrei).  
For all work steps with the silicone symbol: Use suitable silicone for the respective base material. Thoroughly clean the surface prior to using silicone (free of grease).

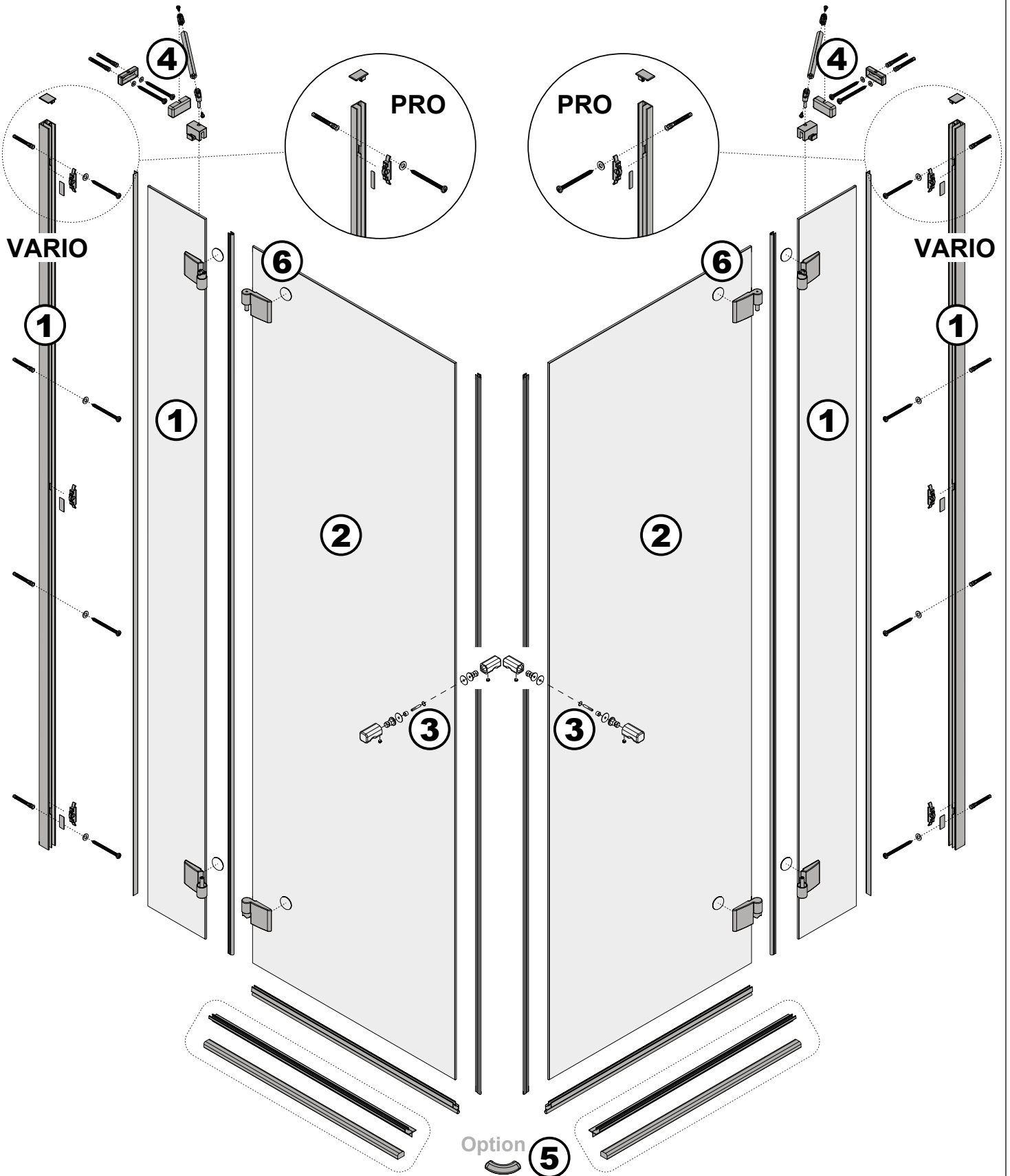



Bei allen Arbeitsschritten mit dem Silikon-Symbol: Für den entsprechenden Untergrund geeignetes Silikon verwenden. Oberfläche vor dem Silikonieren gründlich reinigen (fettfrei).

For all work steps with the silicone symbol: Use suitable silicone for the respective base material. Thoroughly clean the surface prior to using silicone (free of grease).

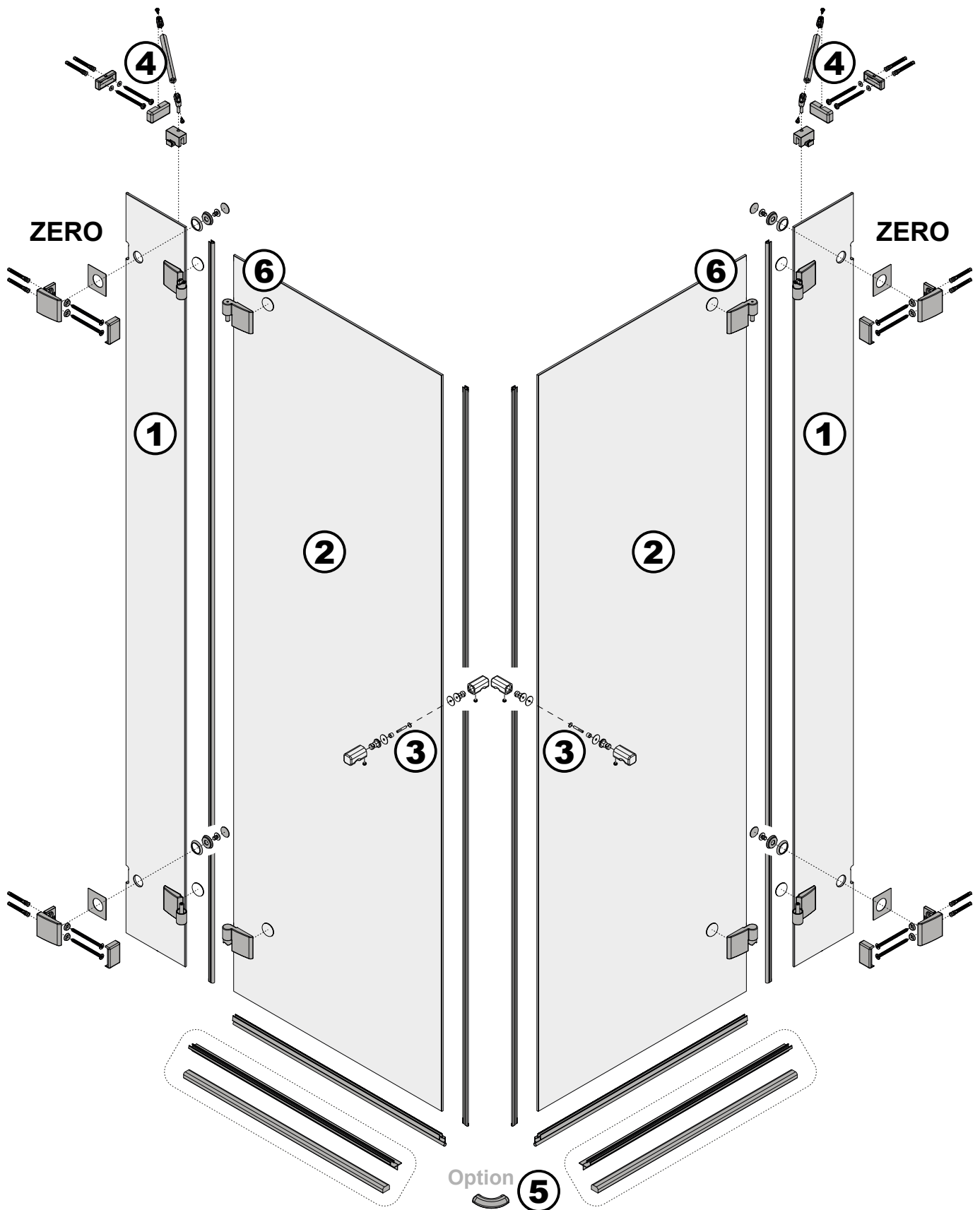

# Einbauinformation

## Installation information

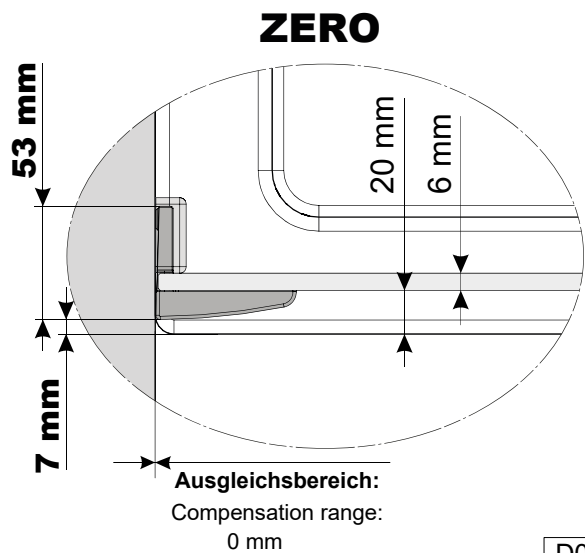
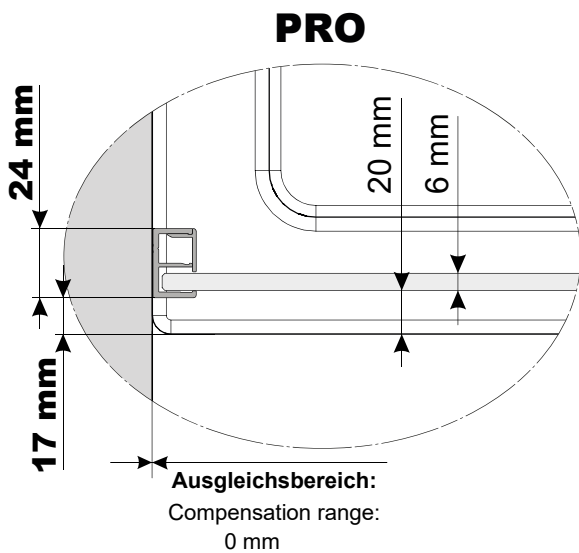
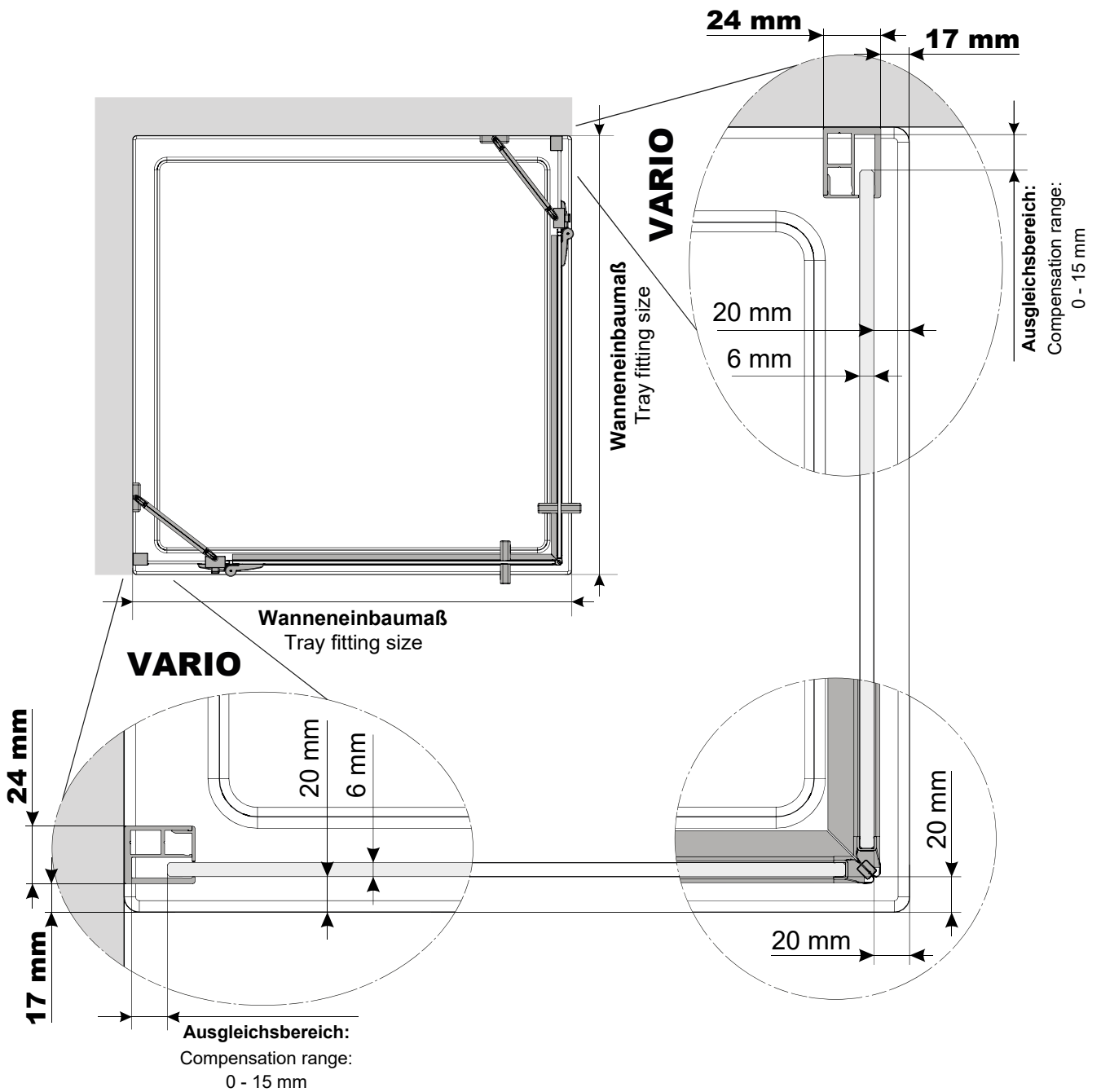

# 1 Vario + Pro

Vario + pro



Schritt 1 (A - D) entfällt bei Ausführung „In Fliese“.  
 Step 1 (A - D) is not applicable for version „in tiling“.

**A**

24 mm  
6 mm  
17 mm  
20 mm

**B**

8 x

**C**

8 x

Ø 6mm

Ø 6x50mm

**D**

8 x

Ø 4,2x50mm

TX20

Vor Montage trocken und fettfrei reinigen.  
 Clean dry and free of grease before mounting.

**E**

6 x

**F**

\*klick\*

6 x

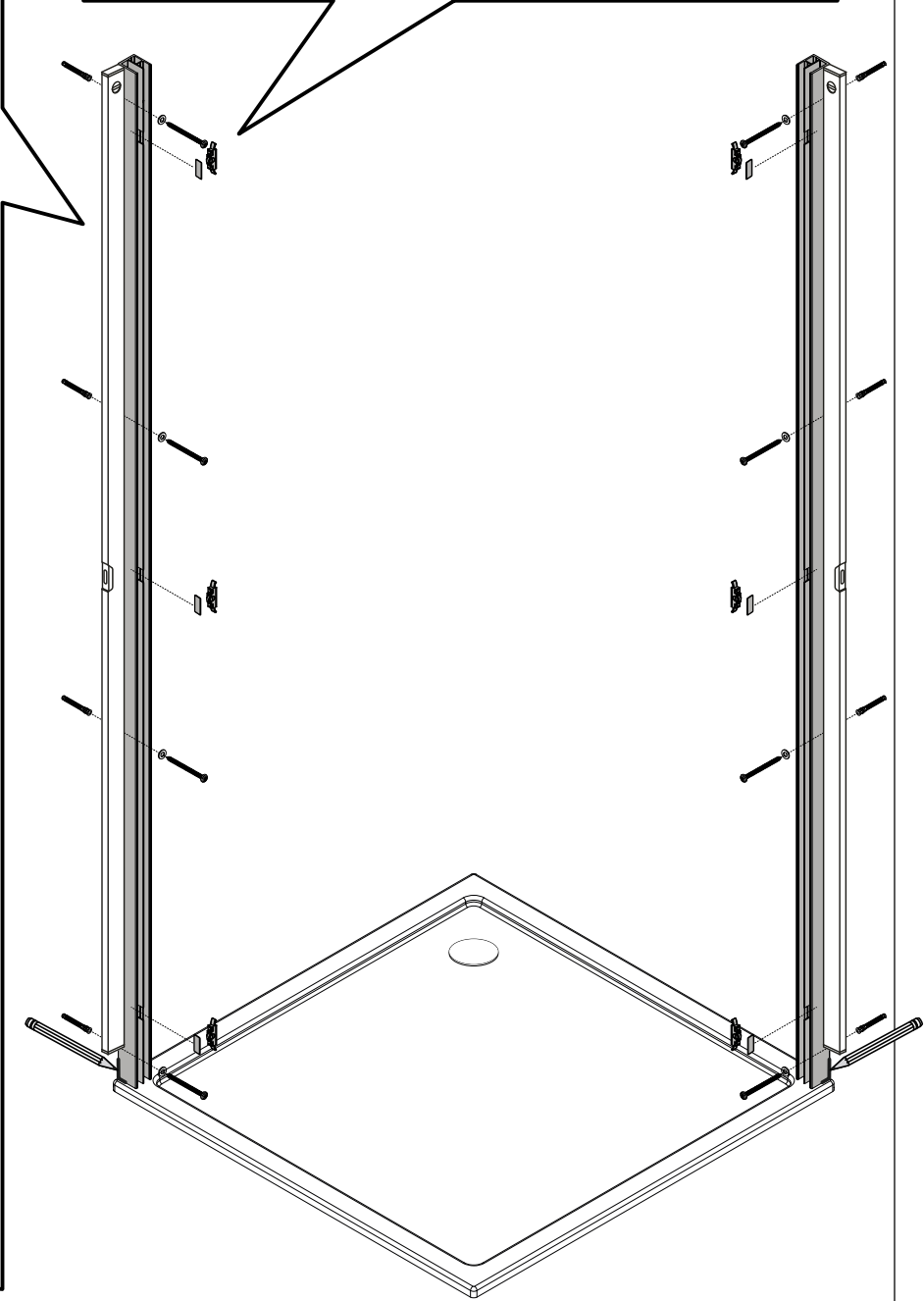

# 1 Vario + Pro

Vario + pro

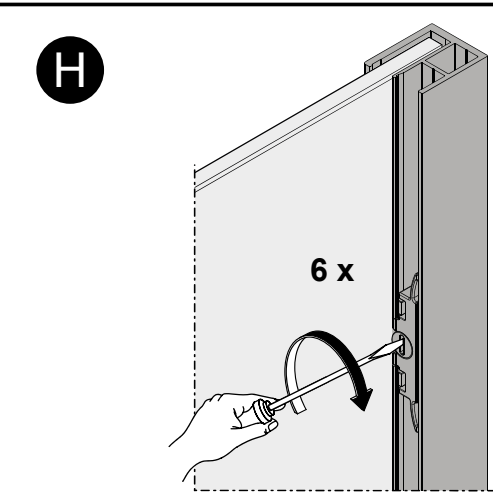
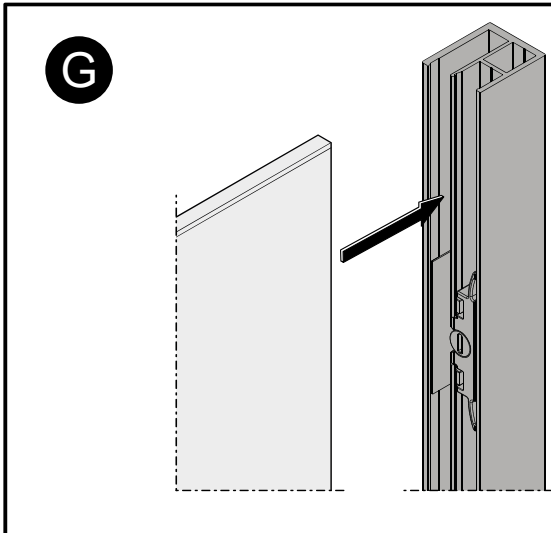

**Schritt I und J erst ab Punkt 6**  
Step I and J mounting at point 6

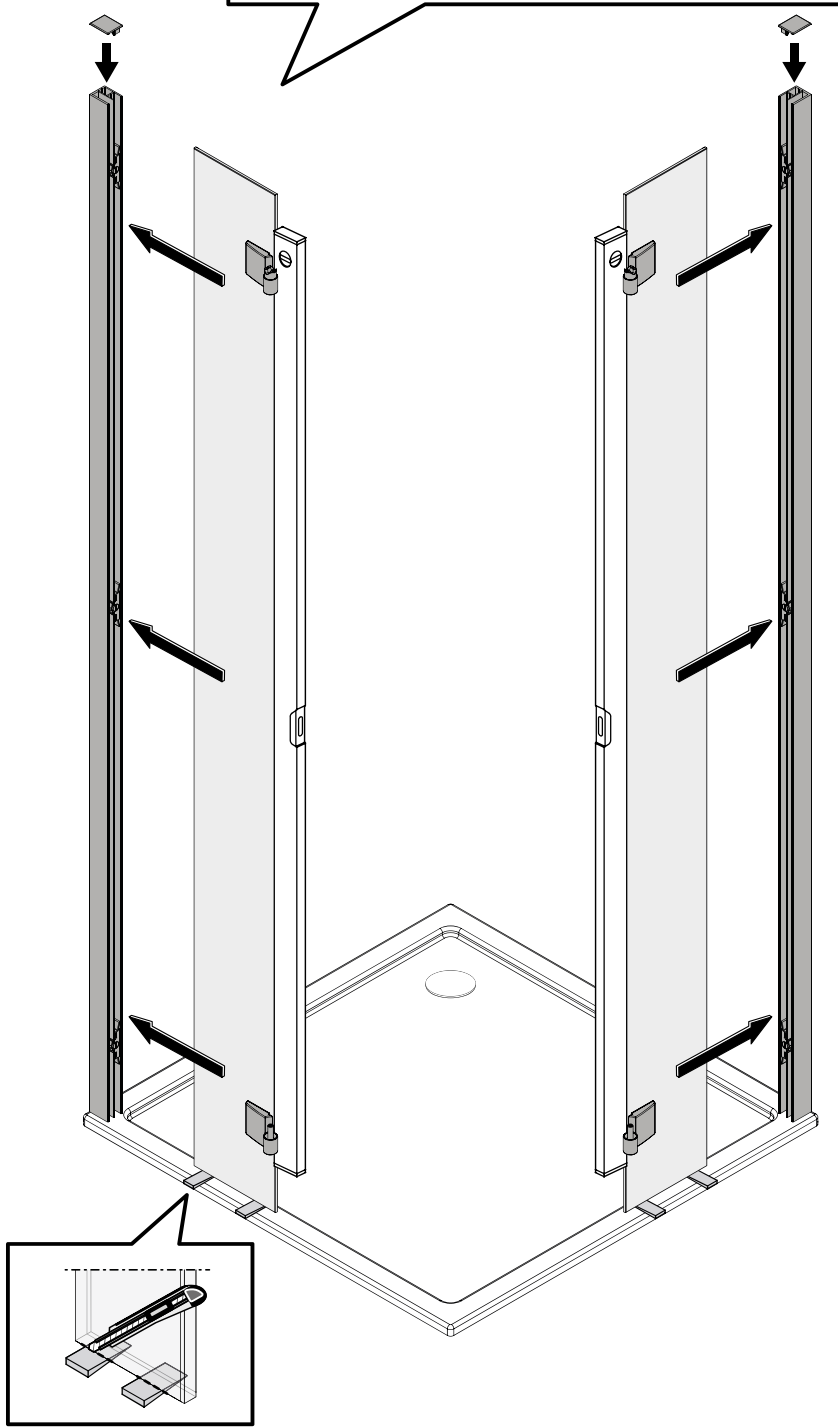
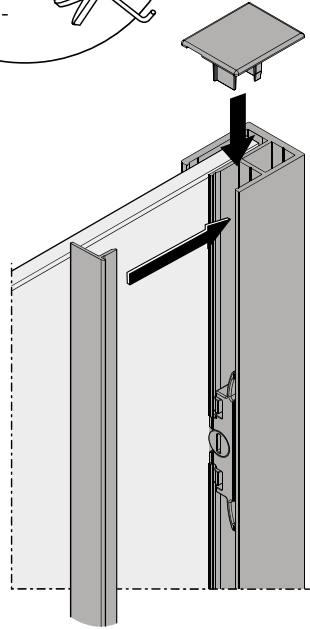
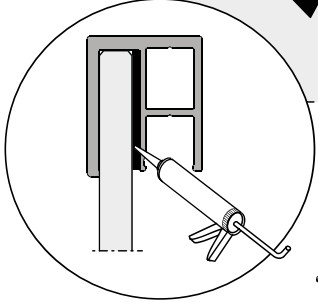
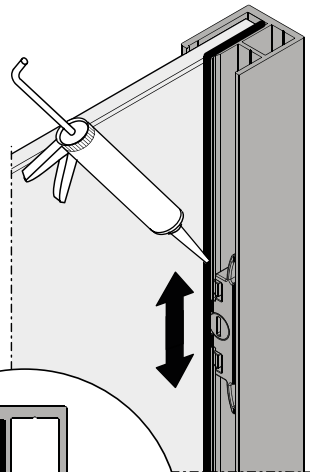

# 1 Zero Zero

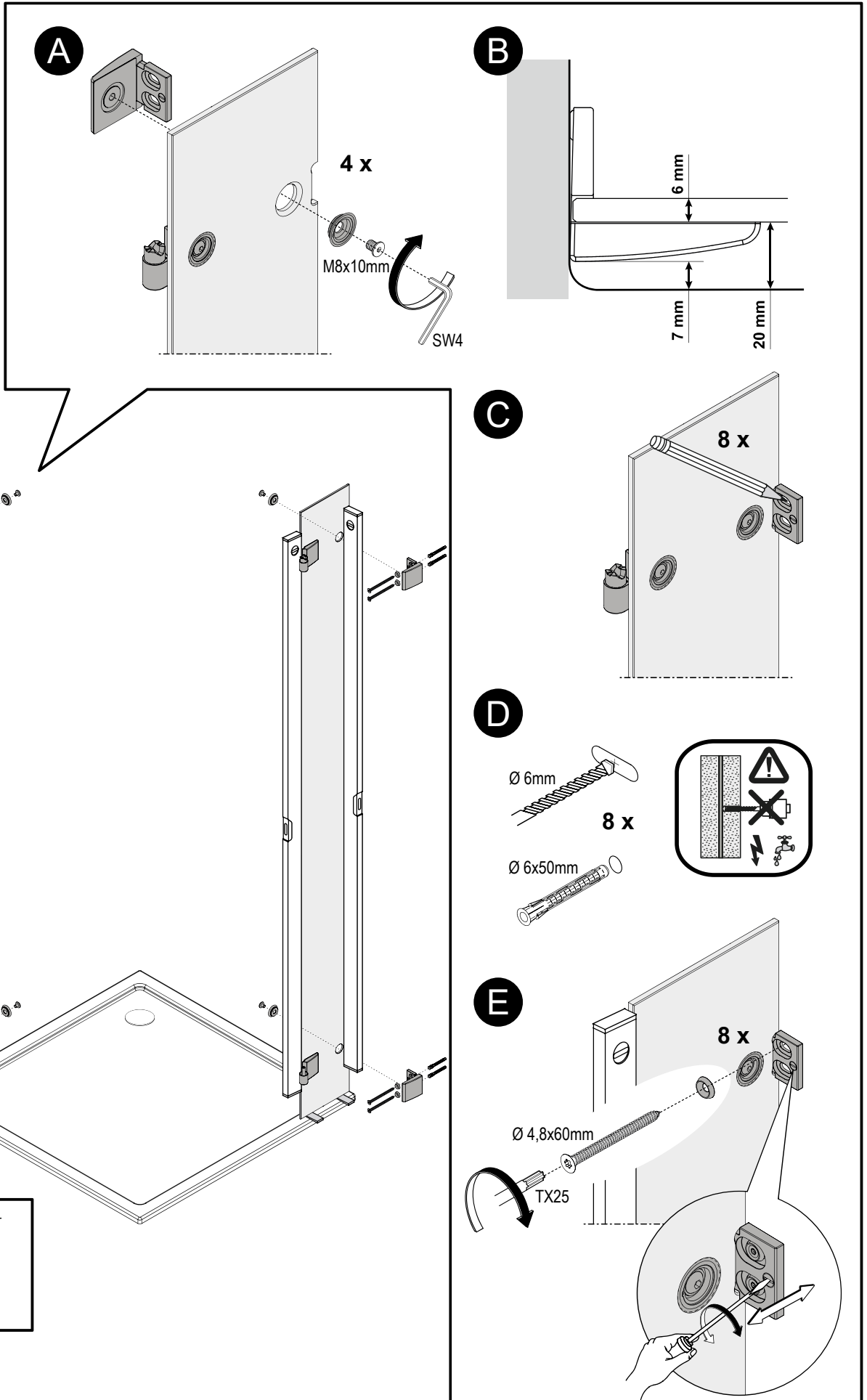

## 2 Alle Varianten All variants



Türblattverstellung, falls erforderlich!  
Door adjustment, if necessary!

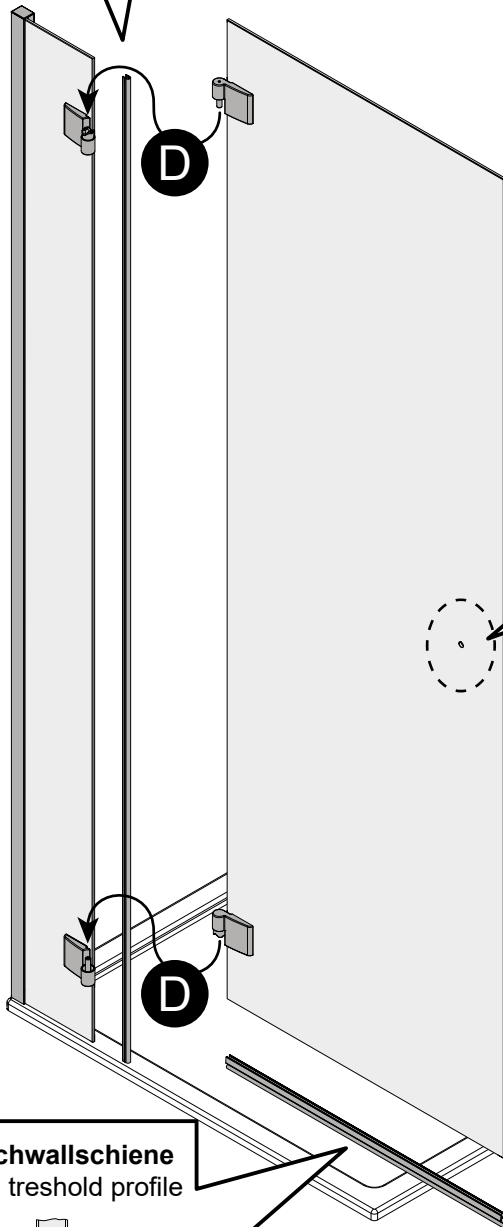
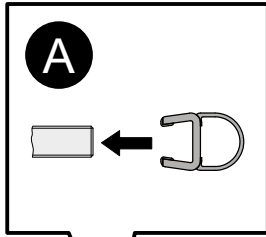
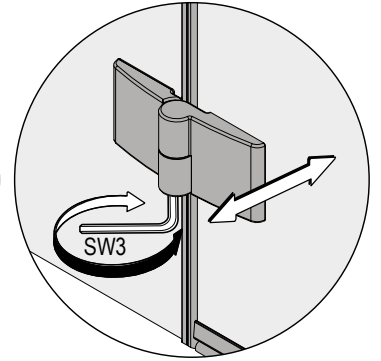
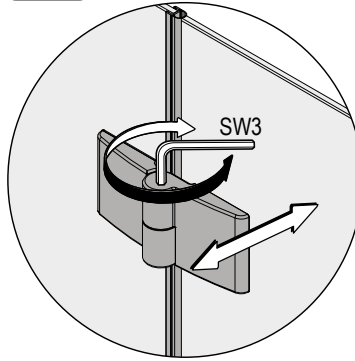

Montage Türflügel  
rechts spiegelbildlich!  
Assembly of right door  
left door likewise!

### 3

lt. Griffmontageanleitung  
see instructions handle mounting

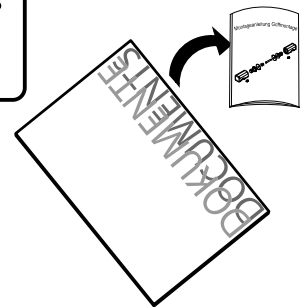

### C

innen  
inside

aussen  
outside

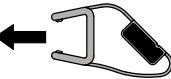

Option: mit Schwallschiene  
optionally: with treshold profile

### B

aussen  
outside

innen  
inside



Standard Dichtung  
standard seal

### B

aussen  
outside

innen  
inside

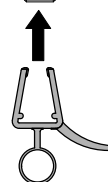

# 4

## Alle Varianten All variants



Montage Bügel  
rechts spiegelbildlich!  
Assembly of right stiffener  
left stiffener likewise!

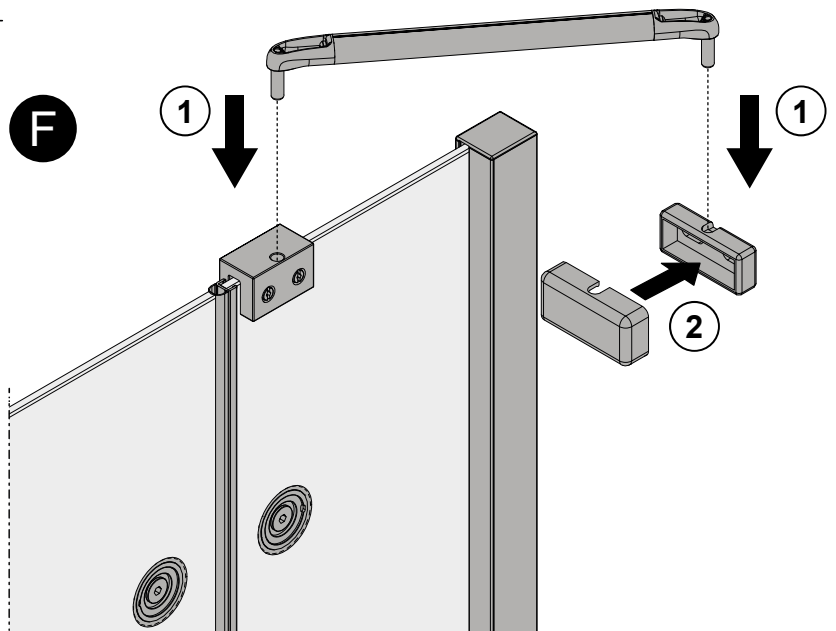
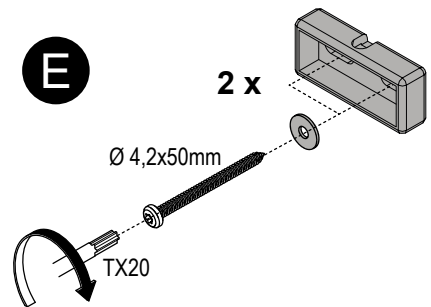
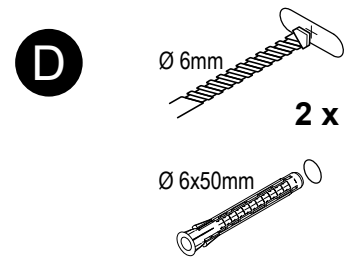
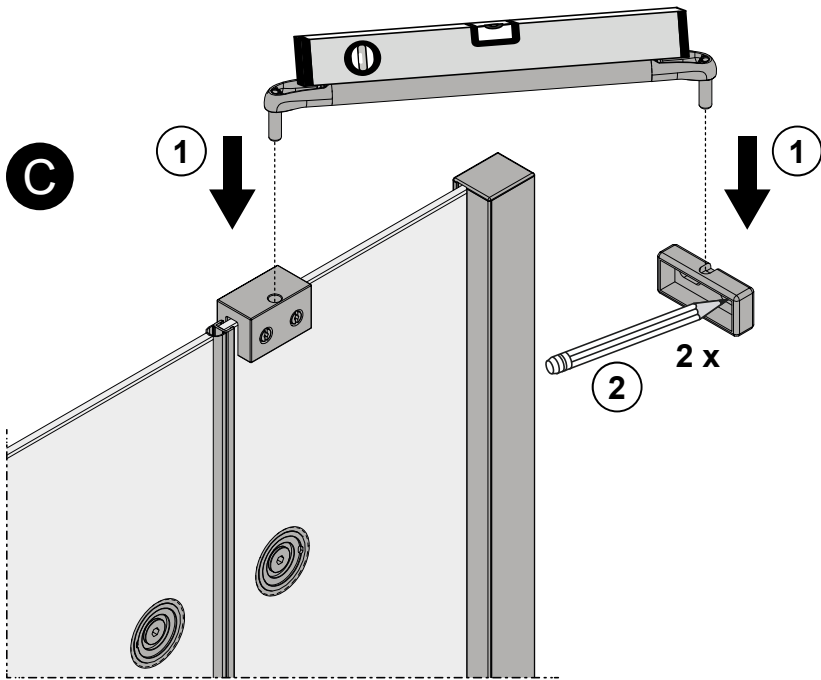
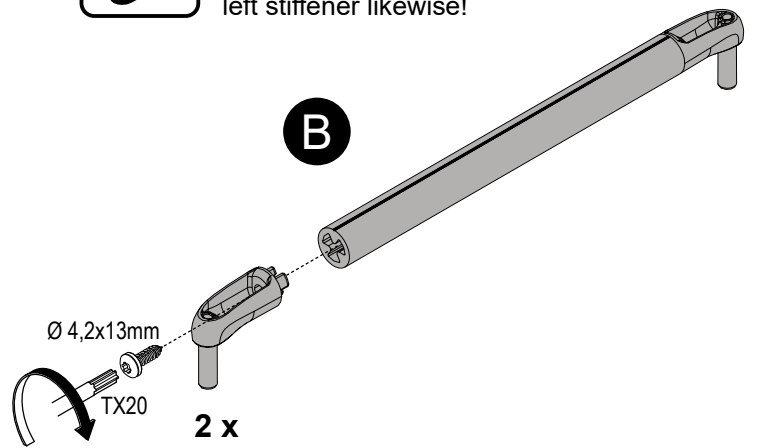
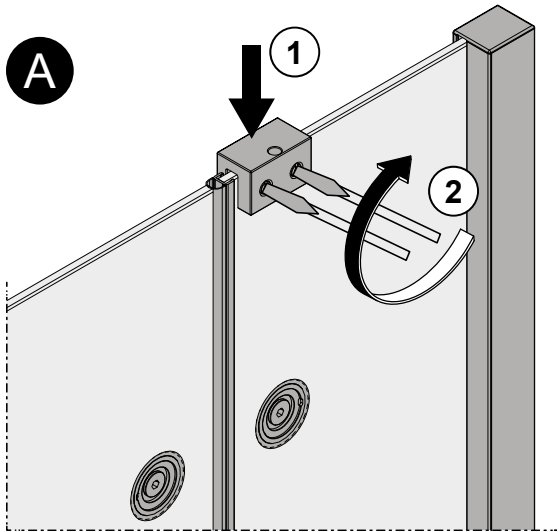

# 5 Option: 4 mm Schwallschiene 4 mm threshold profile

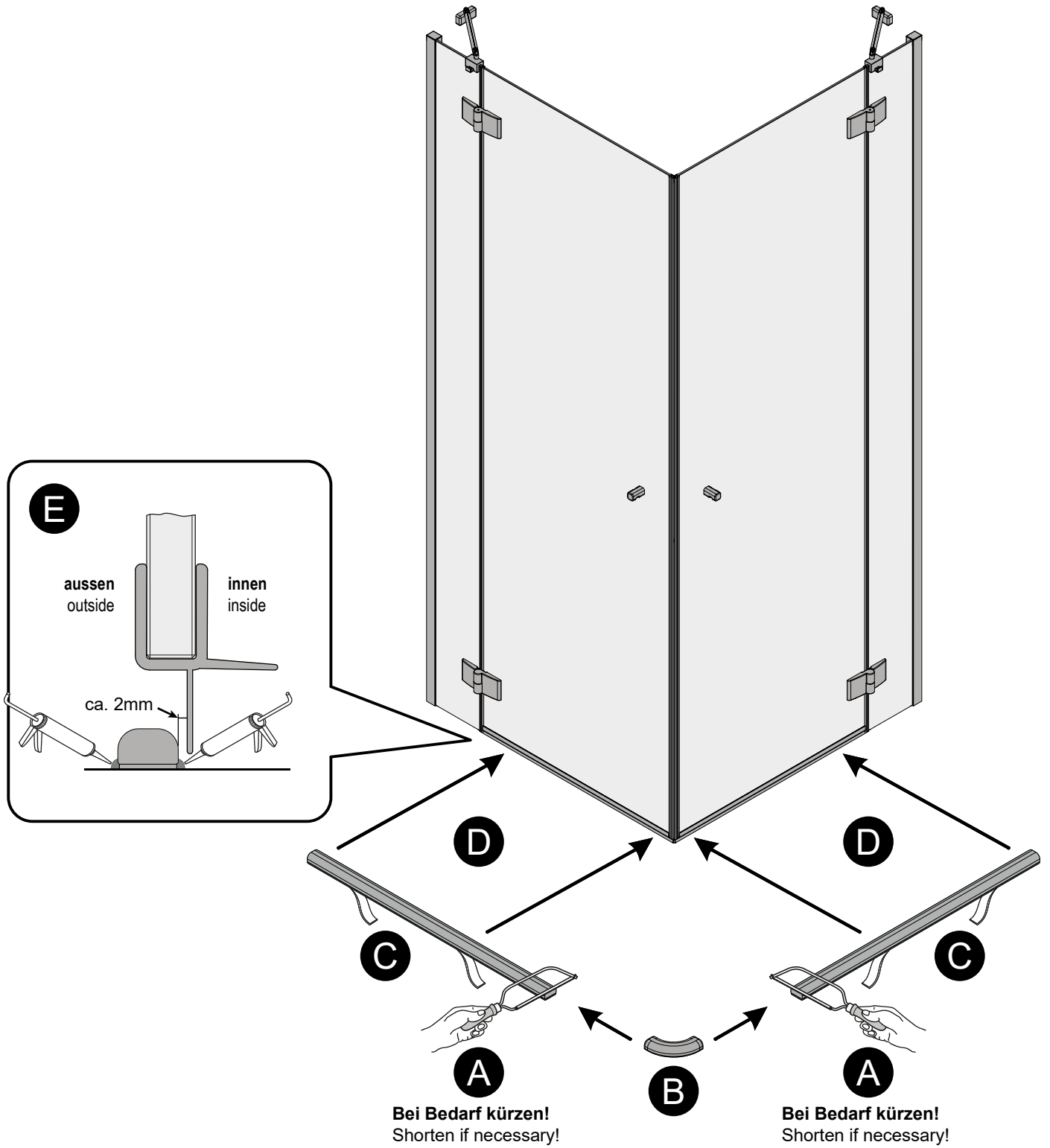

# 6 Vario + Pro Vario + pro



Für den entsprechenden Untergrund geeignetes Silikon verwenden.  
Oberfläche vor dem Silikonieren gründlich reinigen (fettfrei).  
Use suitable silicone for the respective base material.  
Thoroughly clean the surface prior to using silicone.

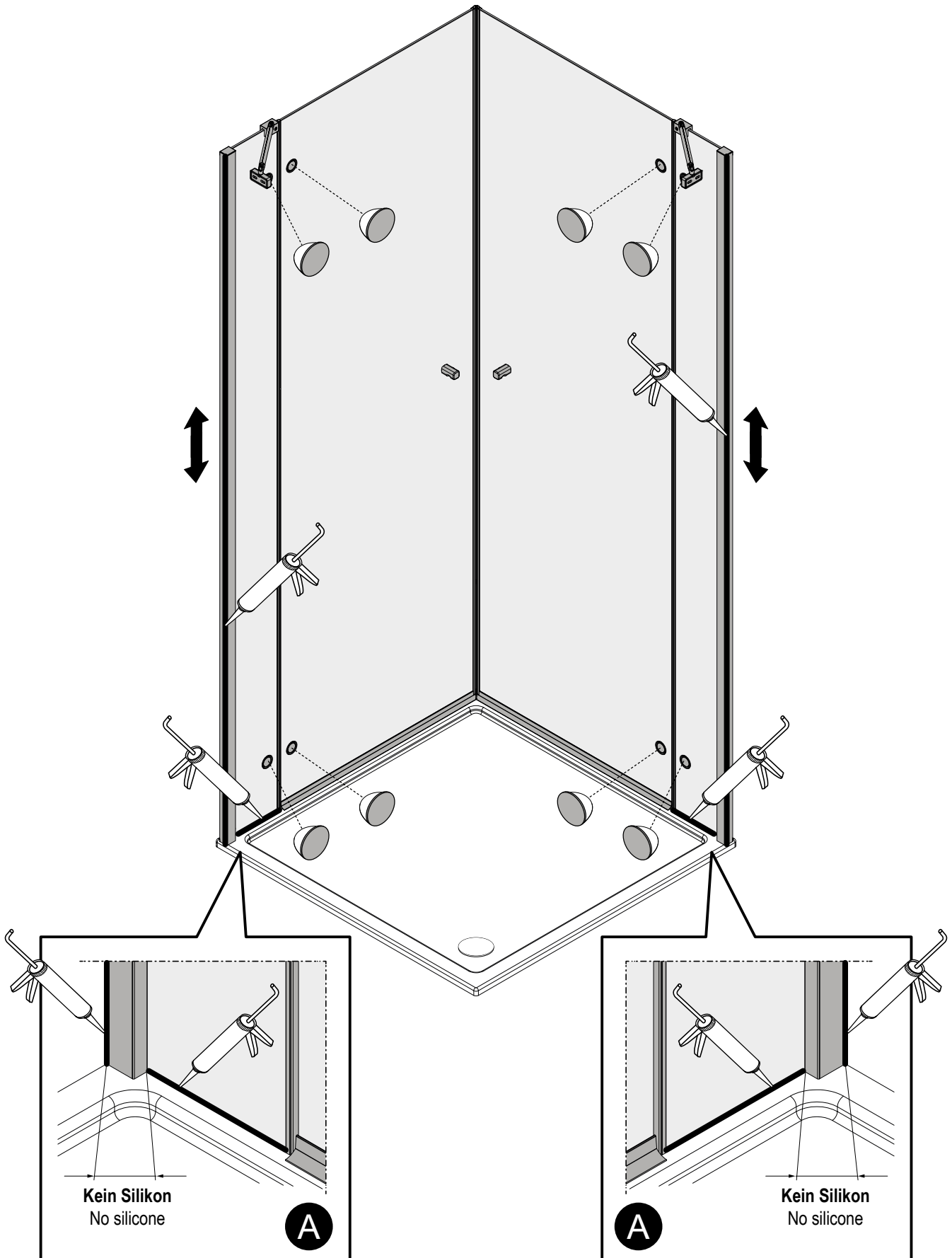

# 6 Zero Zero



Für den entsprechenden Untergrund geeignetes Silikon verwenden.  
Oberfläche vor dem Silikonieren gründlich reinigen (fettfrei).  
Use suitable silicone for the respective base material.  
Thoroughly clean the surface prior to using silicone.

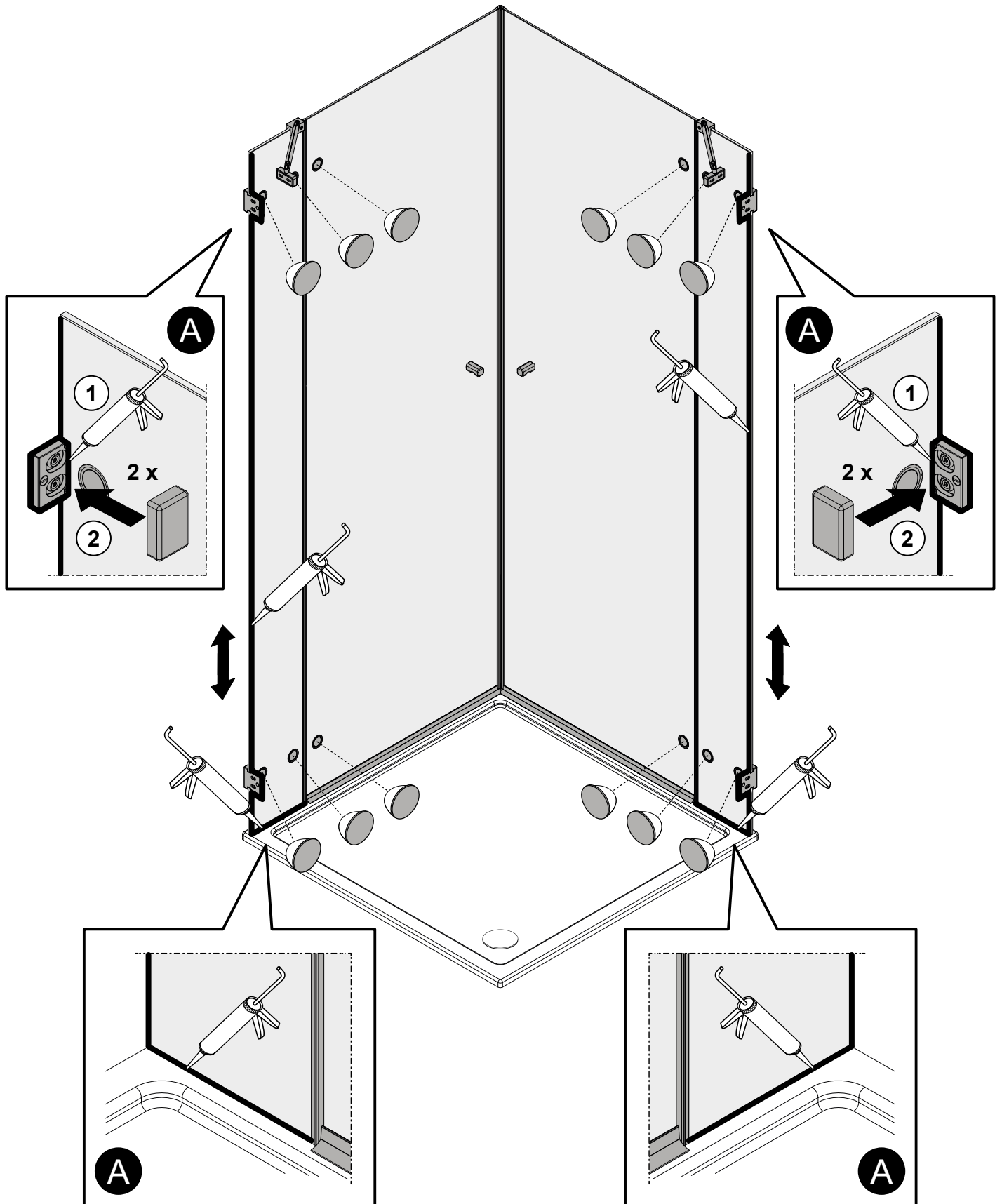

# 6 Vario + Pro Vario + pro



Für den entsprechenden Untergrund geeignetes Silikon verwenden.  
Oberfläche vor dem Silikonieren gründlich reinigen (fettfrei).  
Use suitable silicone for the respective base material.  
Thoroughly clean the surface prior to using silicone.

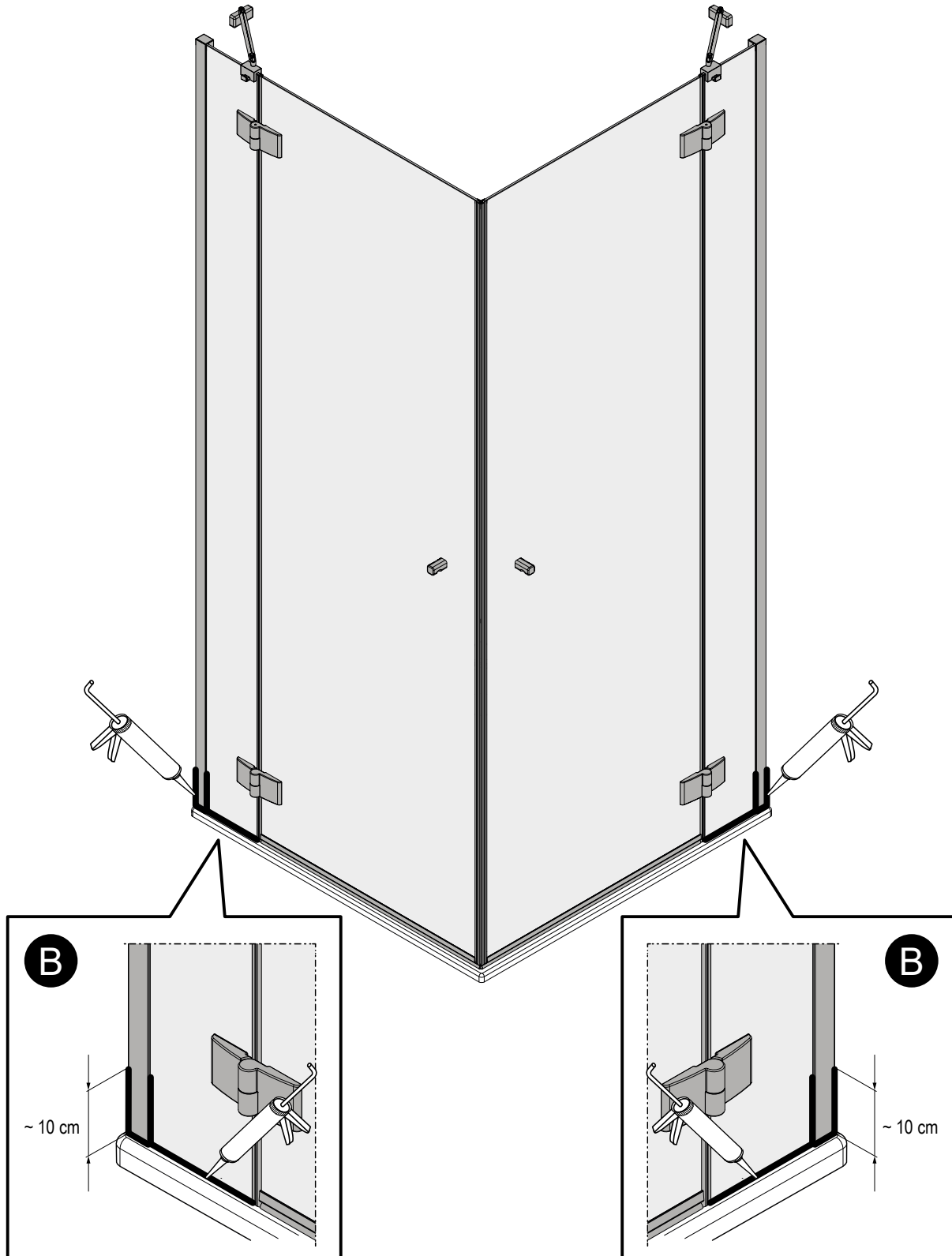

# 6 Zero Zero



Für den entsprechenden Untergrund geeignetes Silikon verwenden.  
Oberfläche vor dem Silikonieren gründlich reinigen (fettfrei).  
Use suitable silicone for the respective base material.  
Thoroughly clean the surface prior to using silicone.

