

Transfero Connect TV 4 - 14 INSTALL

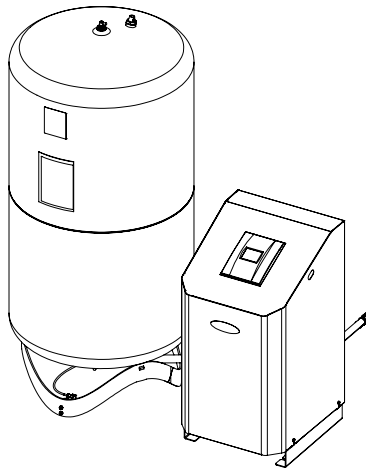

SAFETY - INSPECTION - DISASSEMBLING prescriptions	
1	Read and understand the instructions before using the product.
2	Do not use the product if you are not qualified to do so.
3	Do not use the product if it is damaged or if the instructions are not followed.
4	Do not use the product in an environment with high humidity or high temperature.
5	Do not use the product if the pressure is higher than the maximum allowed pressure.
6	Do not use the product if the pressure is lower than the minimum allowed pressure.
7	Do not use the product if the pressure is not stable.
8	Do not use the product if the pressure is not constant.
9	Do not use the product if the pressure is not uniform.
10	Do not use the product if the pressure is not equal.
11	Do not use the product if the pressure is not balanced.
12	Do not use the product if the pressure is not controlled.
13	Do not use the product if the pressure is not monitored.
14	Do not use the product if the pressure is not regulated.
15	Do not use the product if the pressure is not maintained.
16	Do not use the product if the pressure is not adjusted.
17	Do not use the product if the pressure is not set.
18	Do not use the product if the pressure is not checked.
19	Do not use the product if the pressure is not verified.
20	Do not use the product if the pressure is not confirmed.

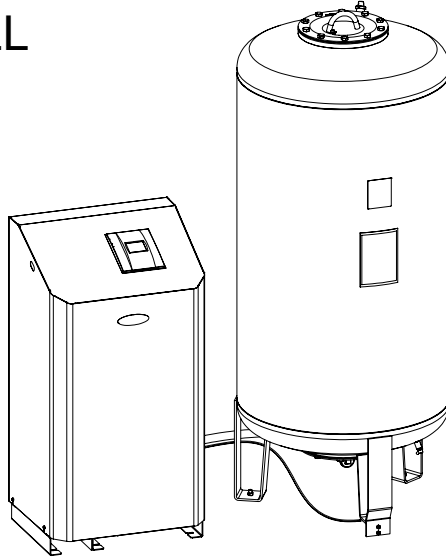

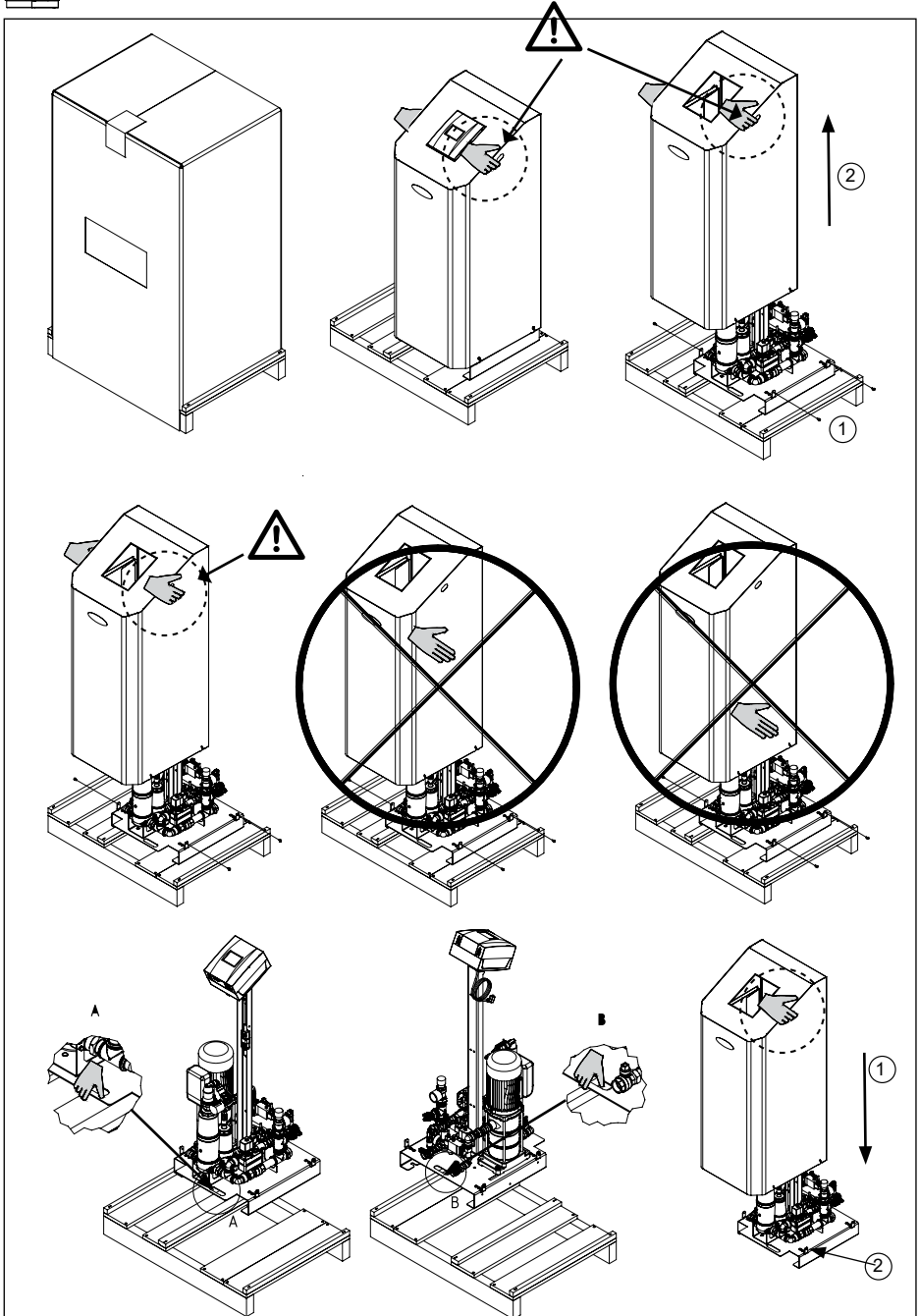
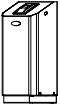

TU Art.Nr. 7463011



TG Art.Nr. 7463012



TU-E Art.Nr. 7463013

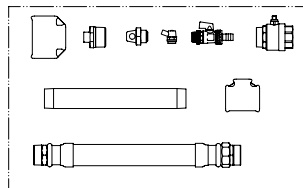

TG-E Art.Nr. 7463014

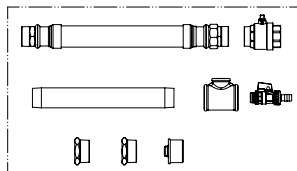

Transfero TU/TUE

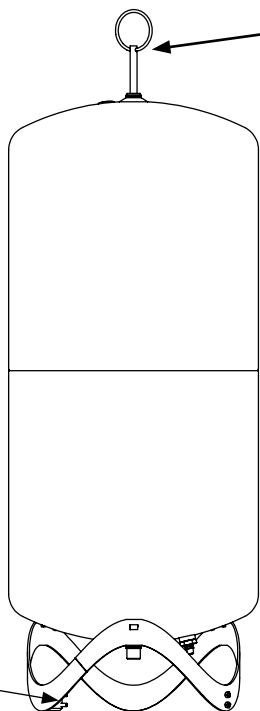

Transfero TG/TGE

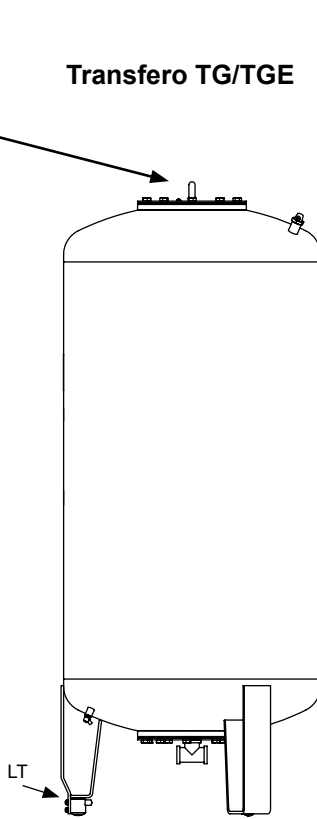

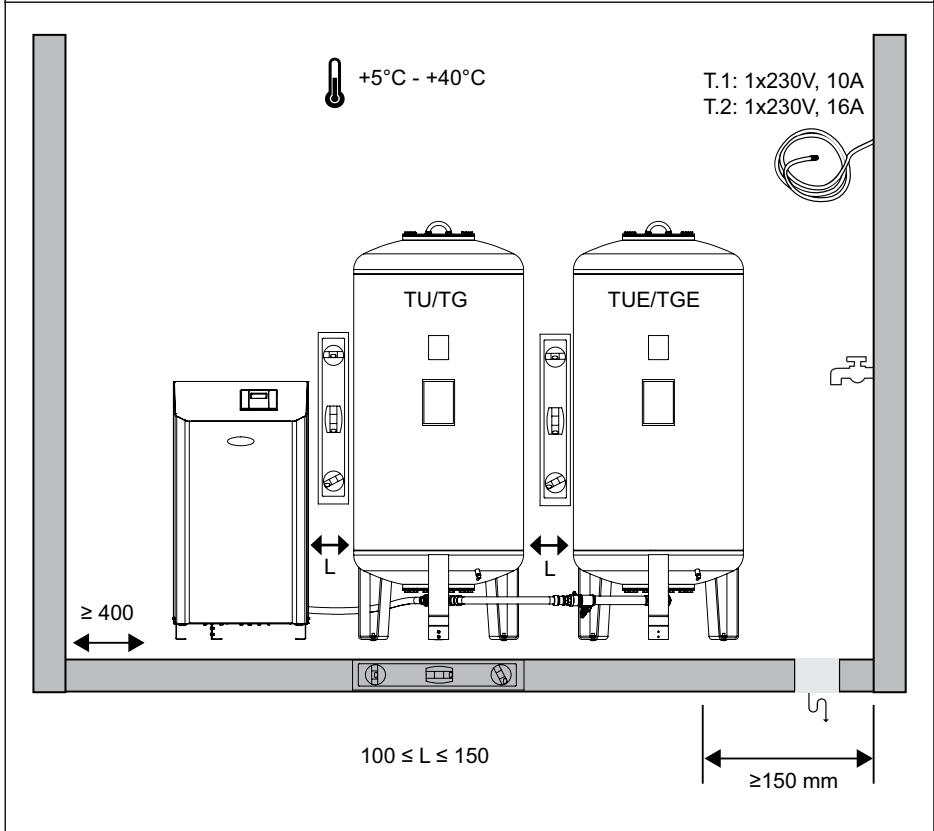
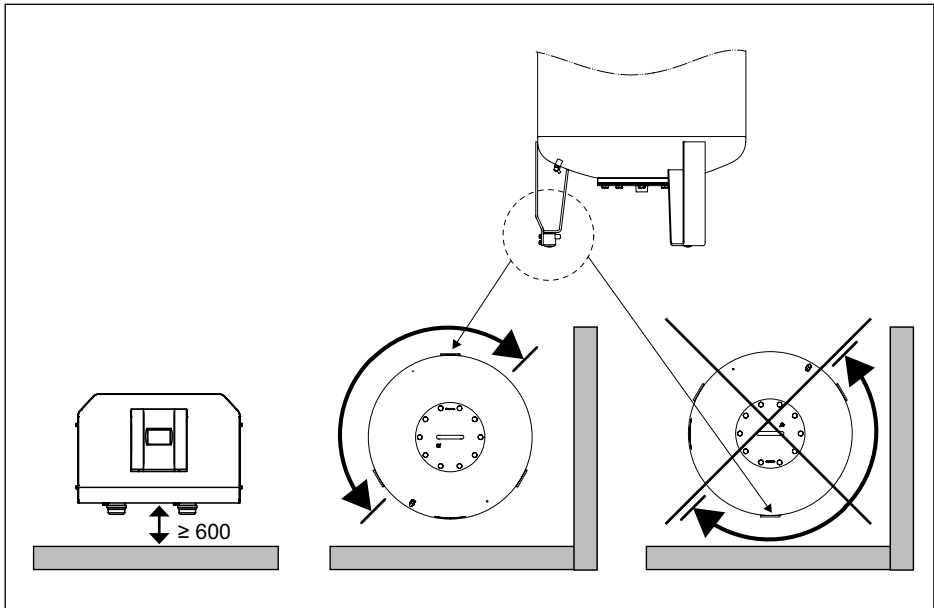

Transfero TU

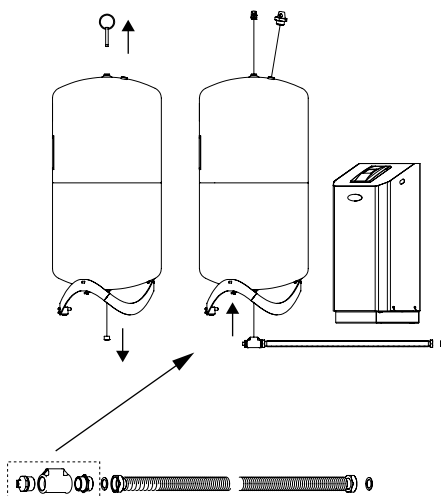

Transfero TUE

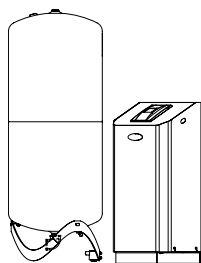
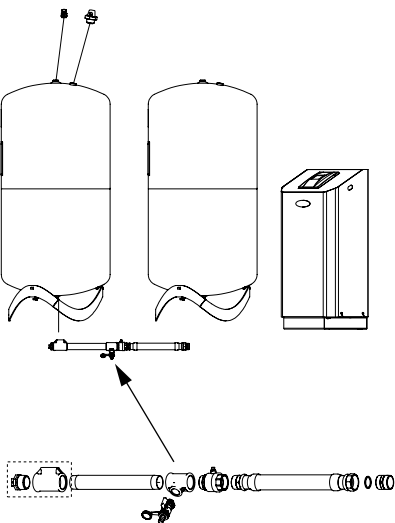

A

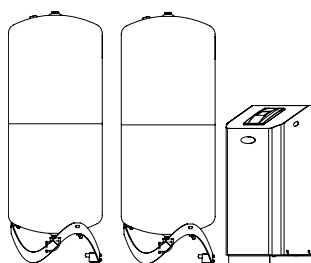

B

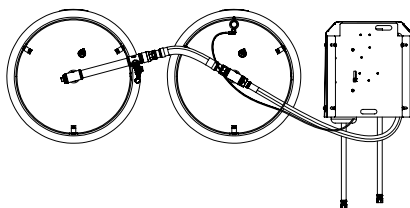
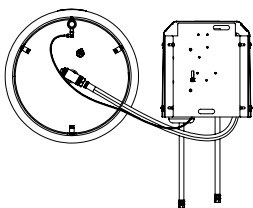

Transfero TG

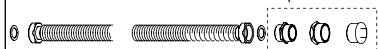
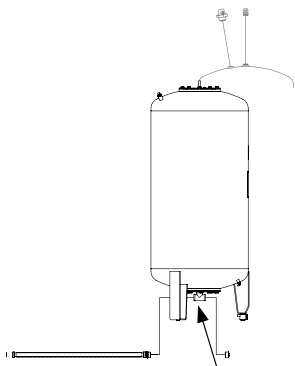

Transfero TG-E

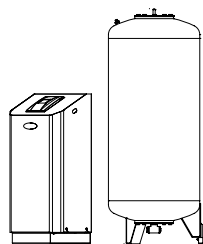
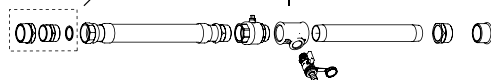
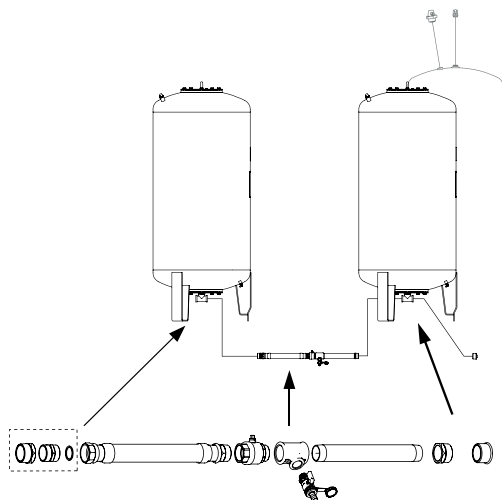

A

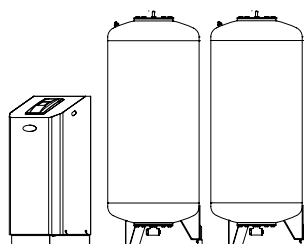
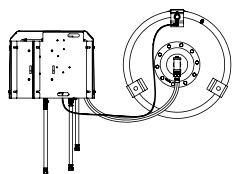

B

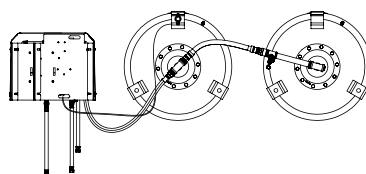

TV.1 E (C) (H)

Optional

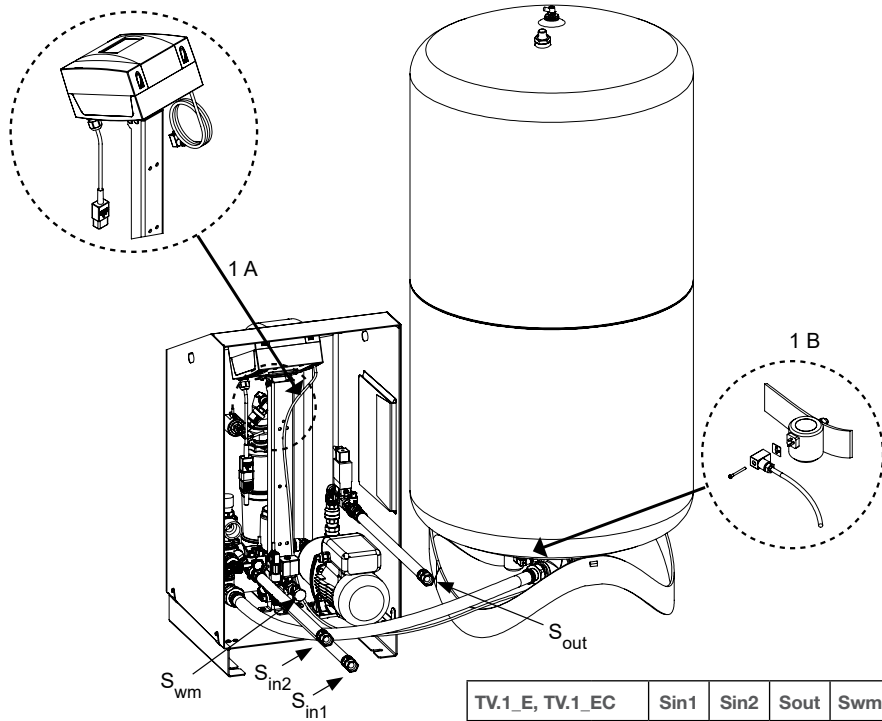
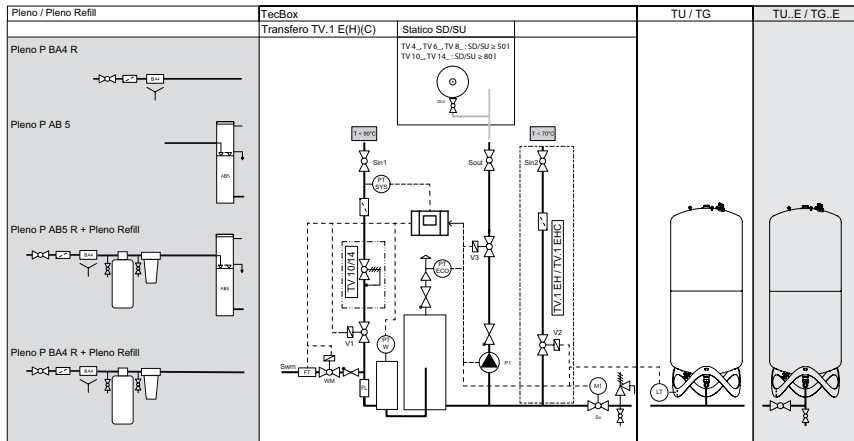

TV.1_E, TV.1_EC	Sin1	Sin2	Sout	Swm
Ts min °C	0		0	0
Ts max °C	70		70	65

	TV_4	TV_6	TV_8	TV_10	TV_14
dpu min bar	1	1,5	2	3,5	5,5
dpu max bar	2,5	3,5	4,5	6,5	10

TV.1_EH, TV.1_EHC	Sin1	Sin2	Sout	Swm
Ts min °C	0	5	0	0
Ts max °C	90	70	90	65

TV.2 E (C) (H)

Optional

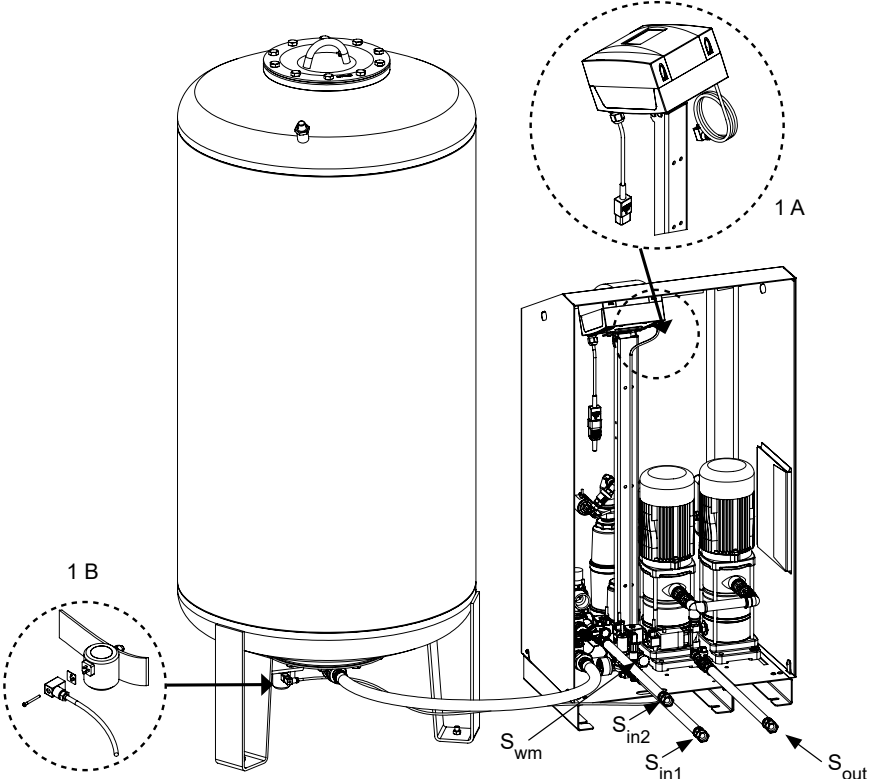
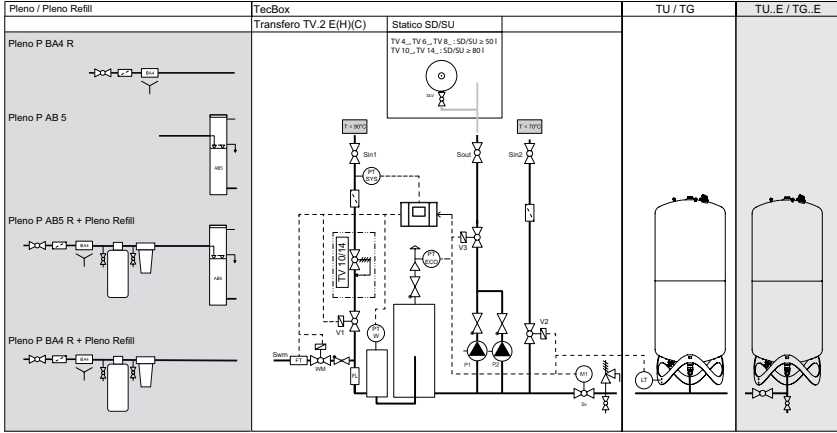

	TV_4	TV_6	TV_8	TV_10	TV_14
dpu min	bar 1	1,5	2	3,5	5,5
dpu max	bar 2,5	3,5	4,5	6,5	10

	TV.2_EH, TV.2_EHC	Sin1	Sin2	Sout	Swm
Ts min	°C	0	5	0	0
Ts max	°C	90	70	90	65



$tr \leq 70^\circ C$

TV.1 E + Pleno BA4 R

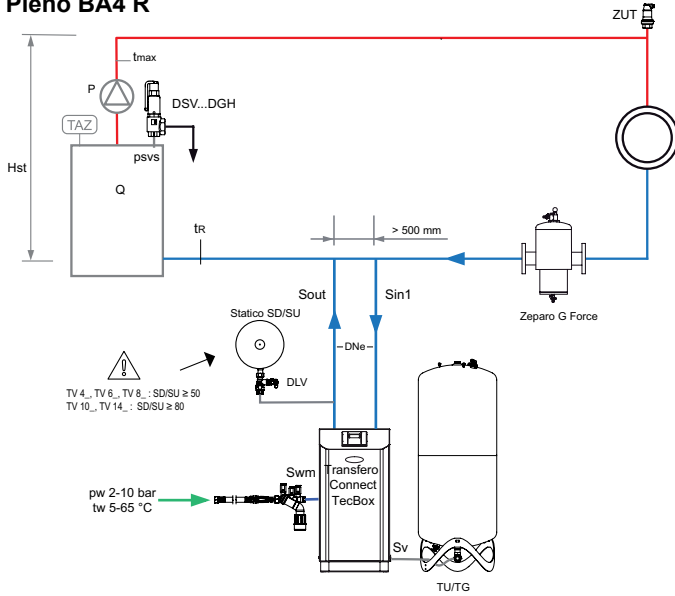

$tr \leq 70^\circ C$

TV.1 E + Pleno AB5 R + Pleno Refill

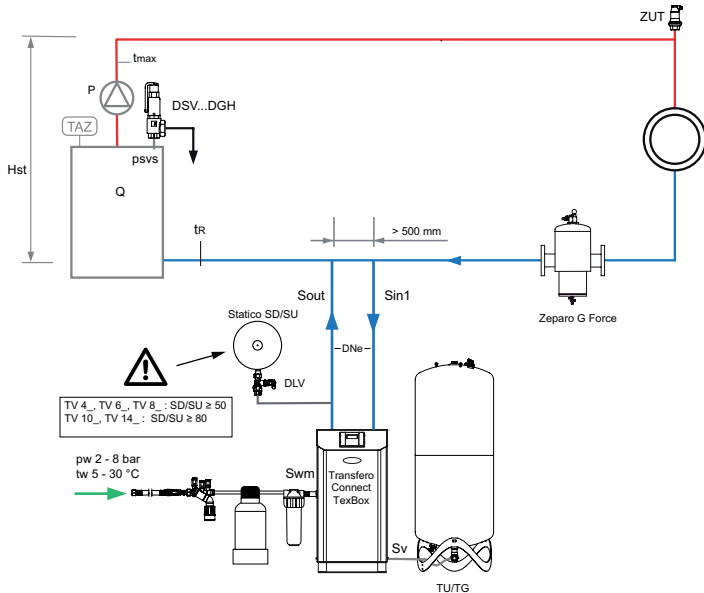



$70^{\circ}\text{C} < tr \leq 90^{\circ}\text{C}$

TV.1 EH / TV.2EH + Pleno P BA4 R + Pleno Refill

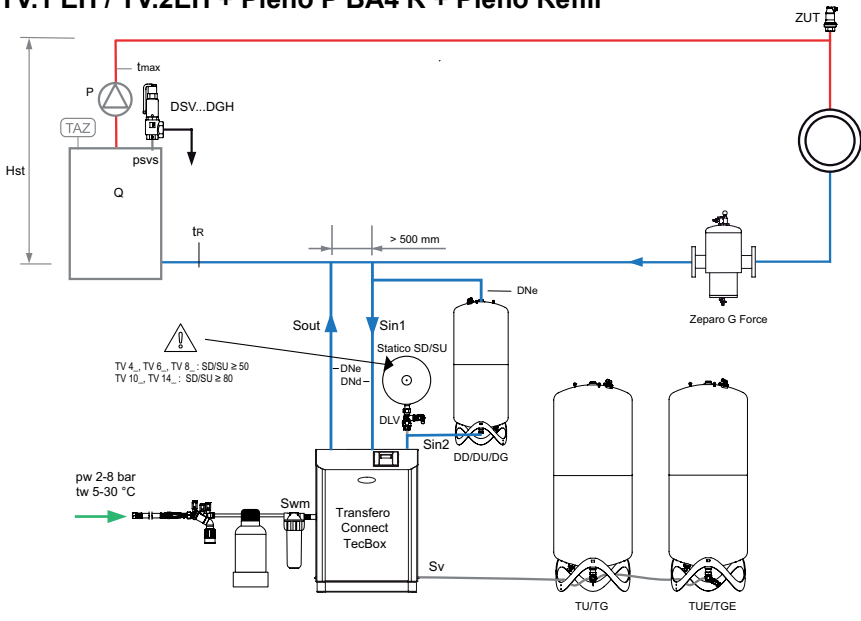

$tr \leq 70^{\circ}\text{C}$

TV.1 EH / TV.2EH + Pleno AB5 R + Pleno Refill

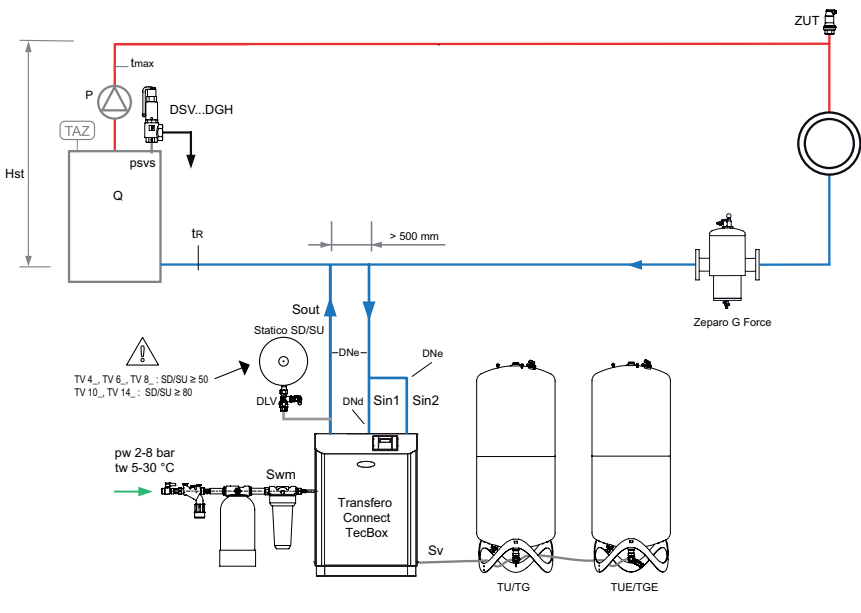



$5^{\circ}\text{C} \leq tr \leq 70^{\circ}\text{C}$

TV.1 EC + Pleno AB4 R + Pleno Refill

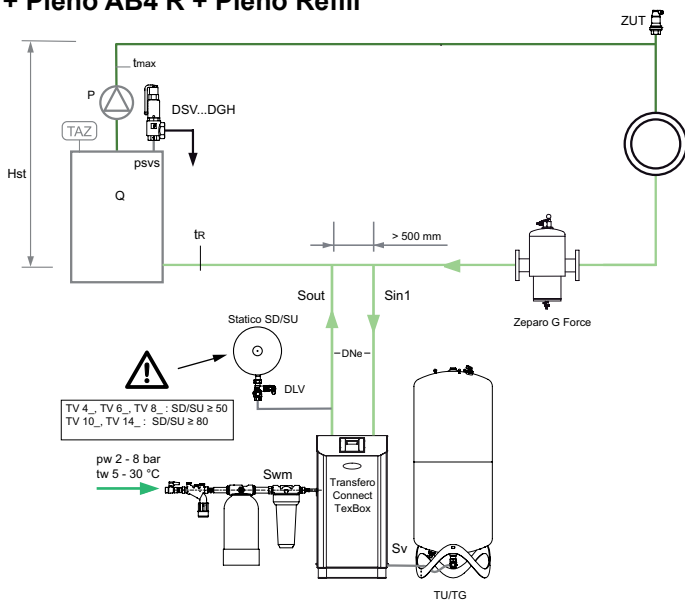

$0^{\circ}\text{C} \leq tr \leq 5^{\circ}\text{C}$

TV.2EHC + Pleno BA4 R

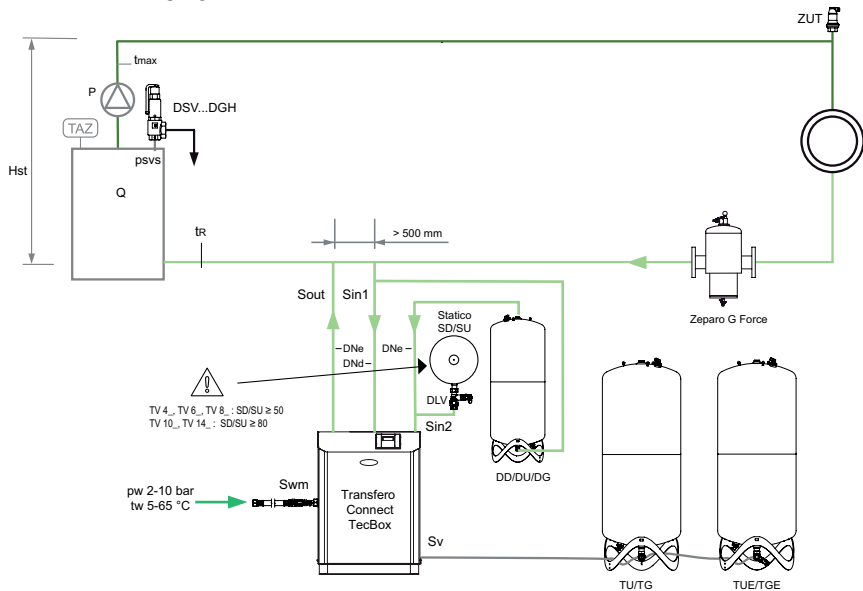



$5^{\circ}\text{C} \leq tr \leq 70^{\circ}\text{C}$

TV.2EHC + Pleno AB5 R + Pleno Refill

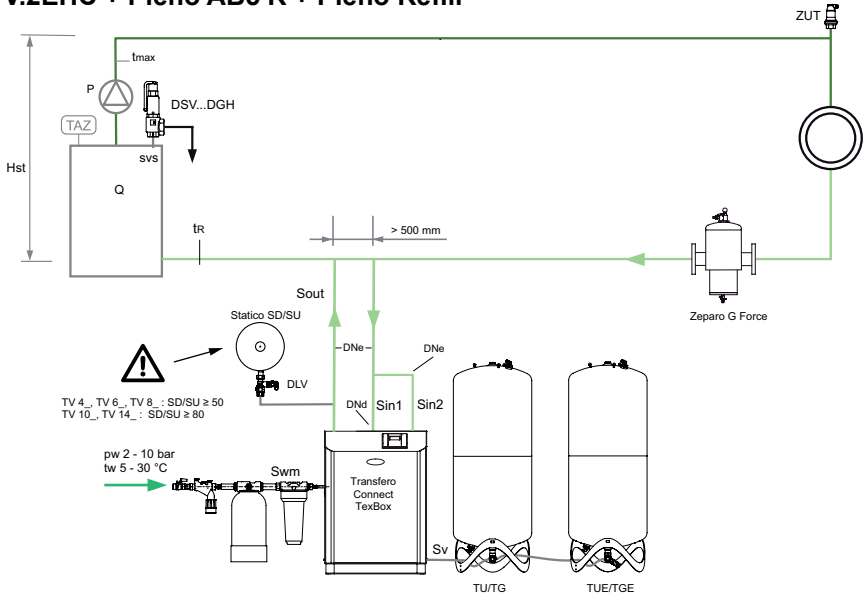

DNe

		TV_4.1	TV_4.1 H	TV_4.2 H	TV_5.1	TV_6.1 H	TV_6.2 H	TV_5.1	TV_8.1 H	TV_8.2 H	TV_10.1	TV_10.1 H	TV_10.2 H	TV_14.1	TV_14.1 H	TV_14.2 H
Length up to approx. 5 m	DNe	25	32	32	25	32	50 40	25	32	50 40	25	40 32	50 40	25	32	50 40
	Hst m	all	all	all	all	all	< 18 ≥ 18	all	all	< 27 ≥ 27	all	< 29 ≥ 29	< 44 ≥ 44	all	all	< 61 ≥ 61
	DNd	25	25	25	25	25	25	25	25	25	25	25	25	25	25	25
Length up to approx. 10 m	DNe	25	32	50 40	25	40 32	50 40	25	40 32	50 40	25	40 32	50 40	25	32	50 40
	Hst m	all	all	< 13 ≥ 13	all	< 23 ≥ 23	< 25 ≥ 25	all	< 24 ≥ 24	< 34 ≥ 34	all	< 40 ≥ 40	< 52 ≥ 52	all	all	< 80 ≥ 80
	DNd	25	25	25	25	25	25	25	25	25	25	25	25	25	25	25
Length up to approx. 30 m	DNe	32	40	50	32	50 40	65 50	32	50 40	65 50	32	50 40	65 50	32	40 32	65 50
	Hst m	all	all	all	all	< 26 ≥ 26	< 22 ≥ 22	all	< 28 ≥ 28	< 30 ≥ 30	all	< 45 ≥ 45	< 48 ≥ 48	all	< 80 ≥ 80	< 70 ≥ 70
	DNd	32	32	32	32	32	32	32	32	32	32	32	32	32	32	32
	Hst m	all	all	all	all	all	all	all	all	all	all	all	all	all	all	all

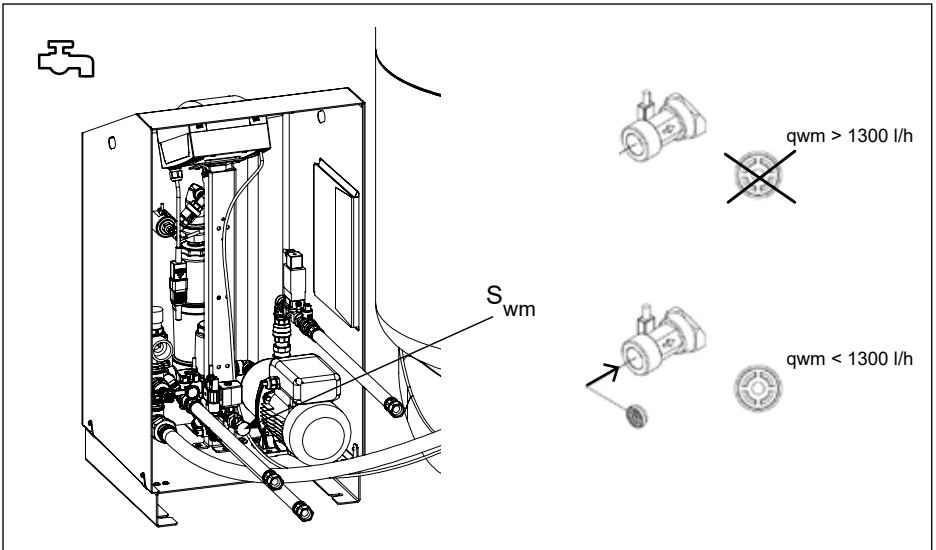
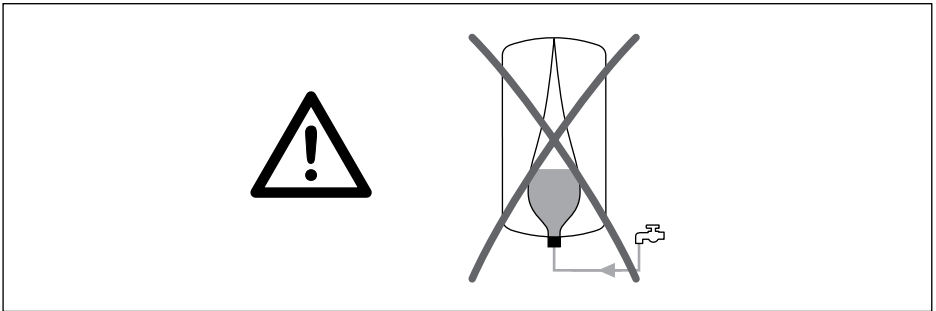

1 x 230V
T.1: 10A / 3 x 1,0 mm²
T.2: 16A / 3 x 1,5 mm²



#1-5

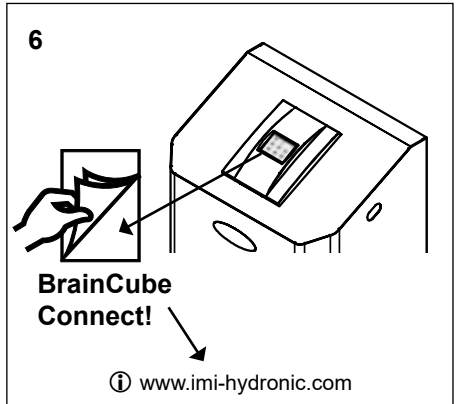
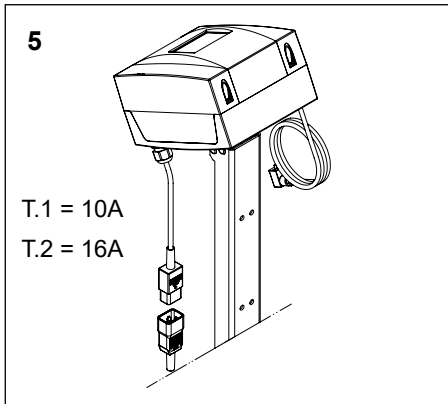
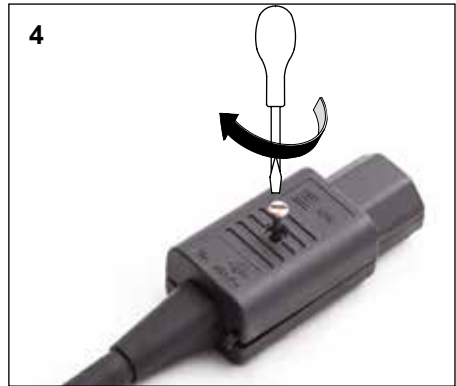
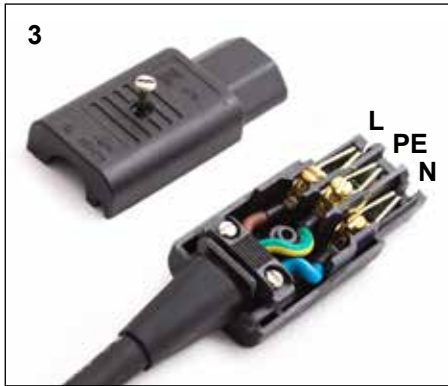
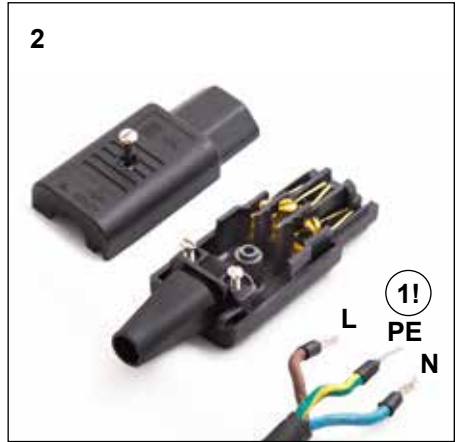
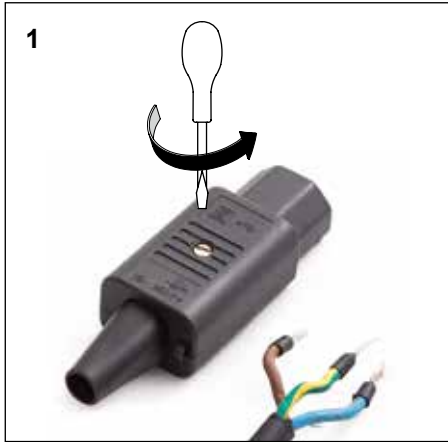
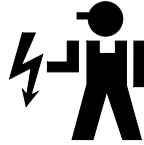



230 V

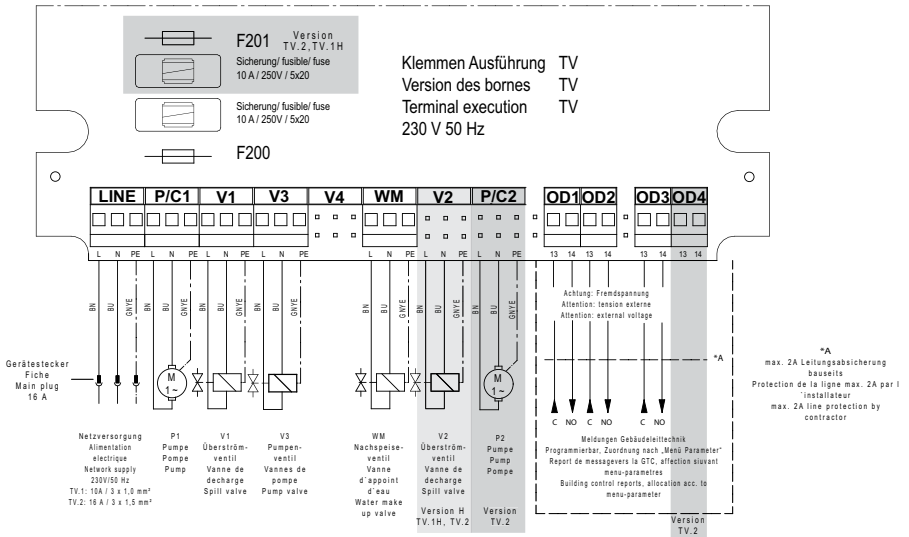

24 V

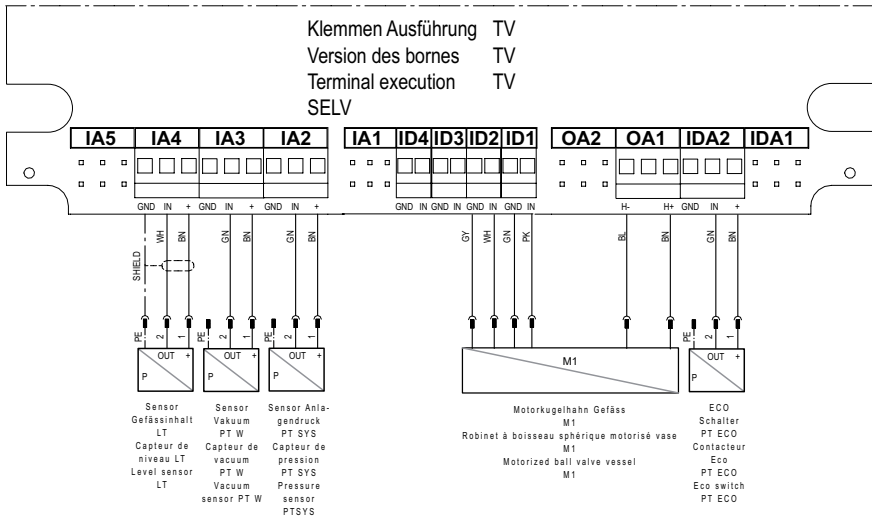

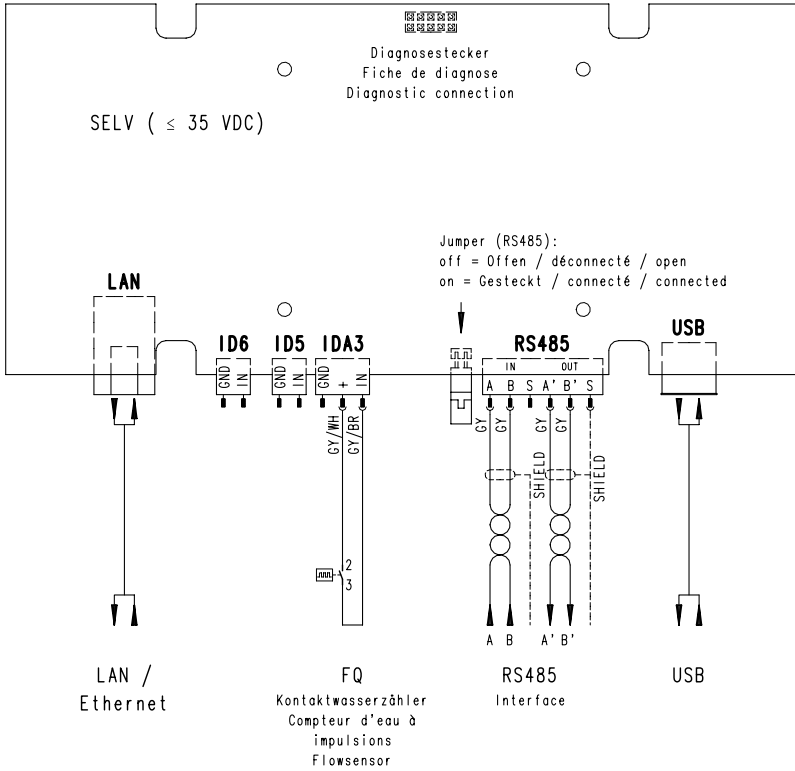

We reserve the right to introduce technical alterations without previous notice.



Hydronic Engineering

www.imi-hydronic.com